

LANDSCAPE PLANTING AND SEEDING NOTES:

- CONTRACTOR SHALL COMPLY WITH THE SPECIFICATIONS FOR PLANTING AND SEEDING AND FOR LANDSCAPING MATERIALS FOUND IN THE R.I.D.O.T. STANDARD SPECIFICATIONS, LATEST EDITION. SPECIFICATION SECTIONS FOR PLANTING AND SEEDING INCLUDE: SECTION L.01 LOAM, PLANTABLE SOIL OR HIGH ORGANIC SOIL, SECTION L.02 - SEEDING, SECTION L.03 SEED STABILIZERS, SECTION L.06-PLANTING, SECTION L.07-EXTENDED ESTABLISHMENT PERIOD, SECTION L.14 HERBICIDE, SECTION M.18 LANDSCAPING MATERIALS.
- ALL PLANT MATERIAL MUST BE TAGGED AT THE NURSERY BY THE LANDSCAPE ARCHITECT.
- THE LANDSCAPE ARCHITECT RESERVES THE RIGHT TO REJECT ANY AND ALL PLANT MATERIAL WHEN DELIVERED TO THE SITE. THE CONTRACTOR SHALL RECEIVE THE PROJECT MANAGER/LANDSCAPE ARCHITECT'S APPROVAL OF PLANT MATERIAL PRIOR TO INSTALLATION.
- NO SUBSTITUTIONS ON PLANT MATERIAL WILL BE ALLOWED WITHOUT THE APPROVAL OF THE PROJECT MANAGER/LANDSCAPE ARCHITECT.
- ALL PLANT MATERIAL IS TO BE FIELD LOCATED BY THE LANDSCAPE ARCHITECT. BEFORE DIGGING, THE CONTRACTOR SHALL STAKE OUT ALL PLANTING BEDS AND FLAG ALL TREES AND EACH INDIVIDUAL SHRUB PRIOR TO UNLOADING PLANTS FROM THE TRUCK.
- THE LANDSCAPE ARCHITECT MUST BE ON SITE TO APPROVE ALL TRIMMING AND CLEARING NECESSARY TO COMPLETE THE WORK AS SHOWN ON THE PLANS.
- ANY TOPSOIL USED AS PLANTABLE SOIL SHALL HAVE A SANDY LOAM TEXTURE RELATIVELY FREE OF SUBSOIL MATERIAL, STONES, ROOTS, LUMPS OF SOIL, TREE LIMBS, TRASH OR CONSTRUCTION DEBRIS AND SHALL CONFORM WITH SECTION M18 OF THE R.I.D.O.T. STANDARD SPECIFICATIONS, LATEST EDITION.
- THE CONTRACTOR SHALL BE RESPONSIBLE FOR TESTING ALL TOPSOIL IN ACCORDANCE WITH THE SPECIFICATIONS AND PROVIDING TEST RESULTS TO THE LANDSCAPE ARCHITECT PRIOR TO PLACING THE TOPSOIL.

- ALL PLANTING BEDS AND PITS TO RECEIVE APPROVED SHREDDED PINE BARK MULCH TO DEPTHS INDICATED ON PLANTING DETAILS.
- PLANT MIX BACKFILL FOR ALL PLANTING HOLES SHALL BE 1 PART HIGH ORGANIC SOIL MATERIAL TO 2 PARTS TOPSOIL/SCREENED LOAM AND MUST COMPLY WITH SECTION M.18 OF THE R.I.D.O.T. STANDARD SPECIFICATIONS, LATEST EDITION.
- FERTILIZER FOR PLANT HOLES TO BE ORGANIC SLOW RELEASE FERTILIZER APPLIED AS PER MANUFACTURER'S DIRECTIONS.
- IF CONTRACTOR USES ORGANIC COMPOST FROM EARTH CARE FARM, CHARLESTOWN, RI, FERTILIZERS ARE NOT REQUIRED. WWW.EARTHCAREFARM.COM 401.364.9930
- LAWN AREAS TO RECEIVE LOAM AND SEED, APPLY LOAM TO THICKNESS OF 4-INCHES. HYDROSEED TO BE APPLIED AS PER SECTION M18.10.2 OF THE RIDOT STANDARD SPECIFICATIONS
- THE CONTRACTOR MUST REVEGETATE ALL DISTURBED AREAS OUTSIDE THE PROJECT LIMITS WITH LOAM AND "RI STATE PARK" SEED MIX.
- THE NORMAL ACCEPTABLE SEASONAL SEEDING DATES ARE SPECIFIED IN SUBSECTION L.02.03 OF THE R.I.D.O.T. STANDARD SPECIFICATIONS, LATEST EDITION.

PLANT SCHEDULE WORK AREA I

TREES	CODE	QTY	BOTANICAL NAME	COMMON NAME	SIZE	CONTAINER
	AL	2	Amelanchier laevis Deciduous flowering tree - 15-foot wide canopy	Allegheny Serviceberry	10' Ht.	B&B
	CA	11	Cercis canadensis 'Ace of Hearts' Deciduous flowering tree - 12-15 foot wide canopy- spring blooms	Ace of Hearts Eastern Redbud	10' Ht.	B&B
	CB	3	Chamaecyparis platifera 'Boulevard' Blue-Green color evergreen. 12 feet tall at maturity. Can be pruned	Boulevard Sawara Cypress	5' Ht.	B&B
	NS	2	Nyssa sylvatica Deciduous tree that has red fall color	Tupelo	3' Cal.	B&B
	PC2	10	Picea glauca 'Conica' Dense evergreen tree. Reaches 10-12 ft height in 20 years.	Dwarf White Spruce	5' Ht.	B&B
	PN	3	Picea omorika 'Nana' Slow growing dark green spruce with a mature height of 6 to 8 feet	Dwarf Serbian Spruce	4' Ht.	B&B
	TC	16	Taxus cuspidata 'Capitata' Evergreen tree growing 10-15 ft tall at maturity	Capitata Japanese Yew	5' Ht.	B&B
	TT	2	Thuja occidentalis 'Techny' Arborvitae growing 12-15 feet tall and 10-15 feet wide at maturity	Techny Arborvitae	4' Ht.	B&B
	UP	2	Ulmus americana 'Princeton'	Princeton American Elm	3' Cal.	B&B

SHRUBS	CODE	QTY	BOTANICAL NAME	COMMON NAME	SIZE	CONTAINER
	AB	3	Azalea x 'Bloom-a-thon' Coral AmazeMENT TM	evrgn Rebloom Azalea coral	3 gal.	
	HE	48	Hydrangea macrophylla 'PIIHM-II TM	Bloomstruck Endless Summer Hydrangea	3' Ht.	B&B
	IS	44	Ilex glabra 'Shamrock' Evergreen shrub growing to 4 feet tall and wide	Shamrock Inkberry Holly	3' Ht.	B&B
	IV	49	Itea virginica 'Henry's Garnet' Deciduous shrub blooming in spring and growing to 6 ft wide and 4 feet tall	Henry's Garnet Sweetspire	3 gal.	Pot
	RP	20	Rosa carolina	Carolina Rose	3 gal.	Pot
	SS	10	Spiraea japonica 'Little Princess'	Little Princess Japanese Spirea	7 gal.	
	VN	13	Vaccinium angustifolium 'North Country' Dwarf low bush blueberry shrub grown 2 to 3 feet tall and wide	North Country Lowbush Blueberry	3 gal.	B&B
	VC	28	Viburnum catesbei Deciduous shrub with white fragrant blooms in April may, growing 5 to 8 feet tall and 5 feet wide	Koreanspice Viburnum	3' Ht.	B&B

PERENNIALS	CODE	QTY	BOTANICAL NAME	COMMON NAME	SIZE	CONTAINER
	HO	56	Hemerocallis x 'Stella de Oro'	Stella de Oro Daylily	1 gal.	

GROUND COVERS	CODE	QTY	BOTANICAL NAME	COMMON NAME	SIZE	CONTAINER	SPACING
	AO	61	Annuals annuals Seasonal NOT IN CONTRACT - MAINTENANCE	Seasonal Annuals mix	8" pot		18" o.c.
	LB	93	Liriope muscari 'Big Blue'	Big Blue Lilyturf	1 gal.		24" o.c.
	SA	23	Sesleria autumnalis	Autumn Moor Grass	1 gal.		24" o.c.

SEED MIX

1. THE FOLLOWING SEED MIX SHALL BE USED FOR SEEDING ALL LAWN AREAS. THIS IS AVAILABLE FROM ALLEN'S SEED SUPPLY, EXETER, RHODE ISLAND. SEED SAMPLE BAG MUST BE SUBMITTED FOR APPROVAL.

2. EQUAL SUBSTITUTIONS WILL BE CONSIDERED.

Product	Analysis	Rate/M sq.	Description
Supplemental Mix	50% Improved Per Eye 25% Improved 40 Blue COT 25% Improved 40 Blue COT 20% Chemagro Fescue	5lbs	Perfect for athletic fields and lawns with full sun

NOTE:
WORK IN WORK ZONE - II TO BE COMPLETED BY THE CITY OF EAST PROVIDENCE UNDER SEPARATE CONTRACT

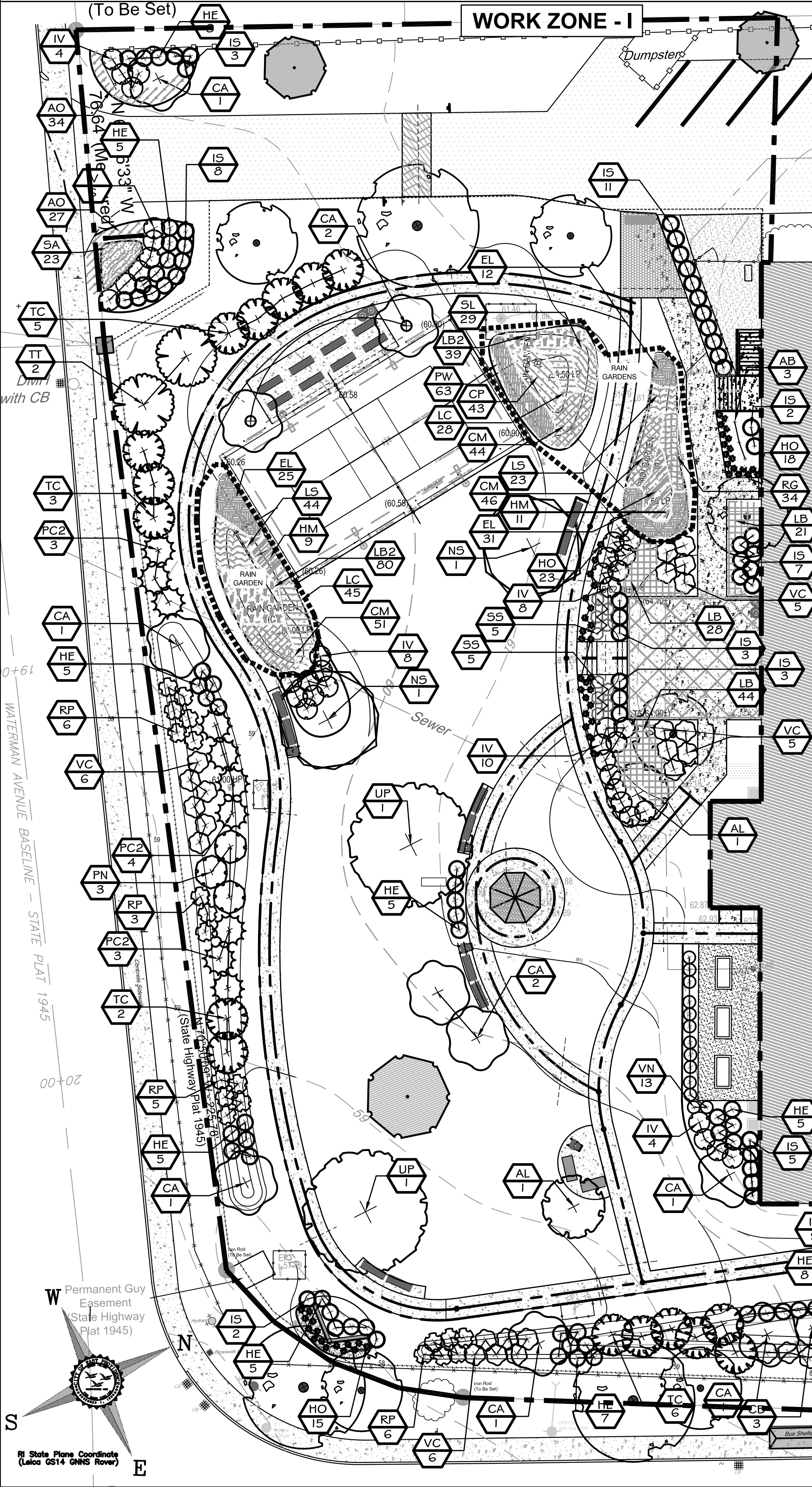

PLANT SCHEDULE RAIN GARDEN

PERENNIAL MASS	CODE	QTY	BOTANICAL NAME	COMMON NAME	SIZE	SPACING	REMARKS
	CP	43	Carex pensylvanica	Pennsylvania Sedge	1 gal.	18" o.c.	
	CM	141	Coreopsis x 'Moonbeam'	Moonbeam Tickseed	1 gal.	18" o.c.	
	EL	68	Eupatorium purpureum 'Little Joe'	Dwarf Joe Pye Weed	1 gal.	24" o.c.	
	HM	20	Hibiscus moscheutos	Rose Mallow	3 gal.	36" o.c.	
	LS	67	Liatris spicata	Blazing Star	1 gal.	18" o.c.	
	LB2	119	Liriope muscari 'Big Blue'	Big Blue Lilyturf	1 gal.	18" o.c.	
	LC	73	Lobelia cardinalis	Cardinal Flower	1 gal.	18" o.c.	
	PW	63	Phlox divaricata	Woodland Phlox	1 gal.	18" o.c.	
	RG	34	Rudbeckia fulgida sullivantii 'Goldsturm'	Goldsturm Coneflower	1 gal.	18" o.c.	
	SL	29	Sisyrinchium angustifolium 'Lucerne'	Lucerne Blue-eyed Grass	1 gal.	18" o.c.	

PLANT SCHEDULE WORK AREA II

TREES	CODE	QTY	BOTANICAL NAME	COMMON NAME	SIZE	CONTAINER
	AT	4	Asimina triloba DOES NOT TRANSPLANT WELL. Fruit can cause demittus and upset stomach	Pawpaw	3' Ht.	
	PN	6	Picea omorika 'Nana' Slow growing dark green spruce with a mature height of 6 to 8 feet	Dwarf Serbian Spruce	4' Ht.	B&B
	TC	3	Taxus cuspidata 'Capitata' Evergreen tree growing 10-15 ft tall at maturity	Capitata Japanese Yew	5' Ht.	B&B
	UP	2	Ulmus americana 'Princeton'	Princeton American Elm	3' Cal.	B&B

BID SET DOCUMENTS

EAST PROVIDENCE SENIOR CENTER
610 WATERMAN AVENUE
EAST PROVIDENCE, RI

COPYRIGHT 2020 LANDSCAPE ELEMENTS, LLC. ALL RIGHTS RESERVED. NO PART OF THIS PUBLICATION MAY BE REPRODUCED, STORED IN A RETRIEVAL SYSTEM OR TRANSMITTED BY ANY MEANS, ELECTRONIC, MECHANICAL, PHOTOCOPYING, RECORDING, OR OTHERWISE WITHOUT THE PRIOR WRITTEN PERMISSION OF LANDSCAPE ELEMENTS LLC.

NOTES

- THESE DRAWINGS ARE THE PROPERTY OF THE LANDSCAPE ARCHITECT, ELIANA M. PASCARIELLA, B.L.A., A.S.L.A. AND LANDSCAPE ELEMENTS, LLC. THEY HAVE BEEN PREPARED FOR THE OWNER FOR THIS PROJECT AT THIS SITE. THESE DRAWINGS ARE NOT TO BE USED FOR ANY OTHER PURPOSE, LOCATION, OR OWNER WITHOUT WRITTEN CONSENT OF THIS OWNER AND/OR THE LANDSCAPE ARCHITECT.
- LANDSCAPE ELEMENTS LLC ASSUMES NO RESPONSIBILITY OR LIABILITY IF THE WORK IS NOT INSTALLED AS PER THE PLANS OR IF FIELD CHANGES ARE MADE WITHOUT THE KNOWLEDGE AND APPROVAL OF THIS LANDSCAPE ARCHITECT.

REVISIONS

STAMPS



DATE: APRIL 12th, 2022
JOB NO: 21-027EPRSCTR
DRAWN BY: EMP
CHECKED BY: EMP/AA

DRAWING TITLE:
PLANTING PLAN AND PLANT LIST

BID SET DOCUMENTS

**EAST PROVIDENCE
 SENIOR CTR
 610 WATERMAN AVENUE
 EAST PROVIDENCE, RI**

COPYRIGHT 2022 LANDSCAPE ELEMENTS, LLC.
 ALL RIGHTS RESERVED. NO PART OF THIS PUBLICATION
 MAY BE REPRODUCED, STORED IN A RETRIEVAL
 SYSTEM OR TRANSMITTED BY ANY MEANS, ELECTRONIC,
 MECHANICAL, PHOTOCOPYING, RECORDING, OR
 OTHERWISE WITHOUT THE PRIOR WRITTEN PERMISSION
 OF LANDSCAPE ELEMENTS LLC.

NOTES
 1. THESE DRAWINGS ARE THE PROPERTY OF THE LANDSCAPE
 ARCHITECT, ELENA M. PASCARELLA, B.L.A., A.S.L.A., AND LANDSCAPE
 ELEMENTS, LLC. THEY HAVE BEEN PREPARED FOR THE OWNER
 FOR THE PROJECT AT THIS SITE. THESE DRAWINGS ARE NOT TO BE
 USED FOR ANY OTHER PURPOSE, LOCATION, OR OWNER WITHOUT
 WRITTEN CONSENT OF THIS OWNER AND/OR THE LANDSCAPE
 ARCHITECT.
 2. LANDSCAPE ELEMENTS LLC ASSUMES NO RESPONSIBILITY OR
 LIABILITY IF THE WORK IS NOT INSTALLED AS PER THE PLANS OR IF
 FIELD CHANGES ARE MADE WITHOUT THE KNOWLEDGE AND
 APPROVAL OF THIS LANDSCAPE ARCHITECT.

REVISIONS

STAMPS



DATE: APRIL 12TH, 2022
 JOB NO.: 21-027-EPSRCTR
 DRAWN BY: EMP
 CHECKED BY: EMP/AA

**DRAWING TITLE:
 DETAILS**

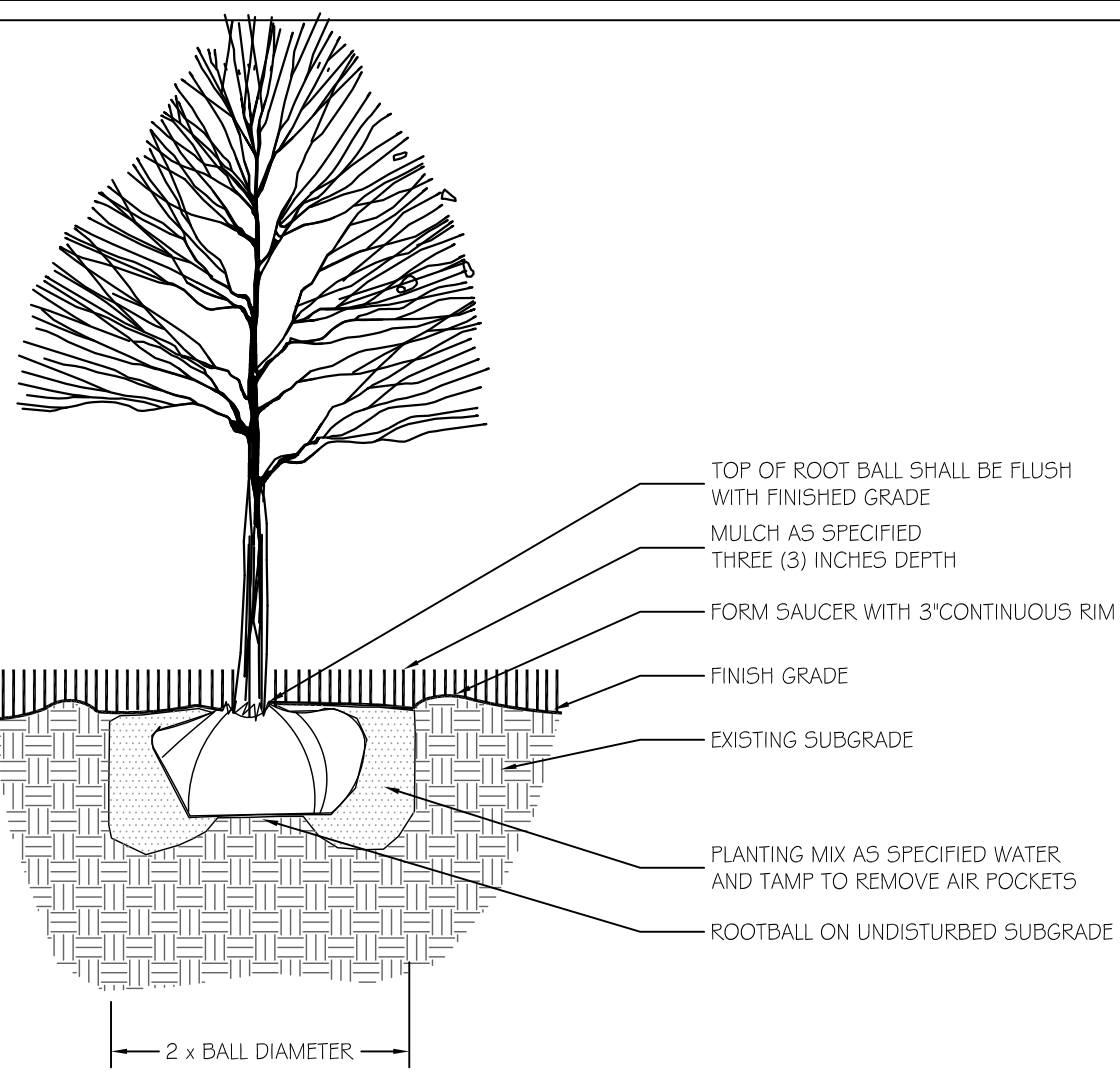

NOTES
 1. DO NOT STAKE TREES UNLESS SOIL IS VERY SANDY OR AS DIRECTED BY LANDSCAPE ARCHITECT.
 2. PLANT SO THAT TOP OF ROOT BALL IS EVEN WITH THE FINISHED GRADE.
 3. PAINT ALL CUTS OVER 1 INCH DIAMETER.

1 DECIDUOUS TREE
 SCALE: 1/2" = 1'-0"

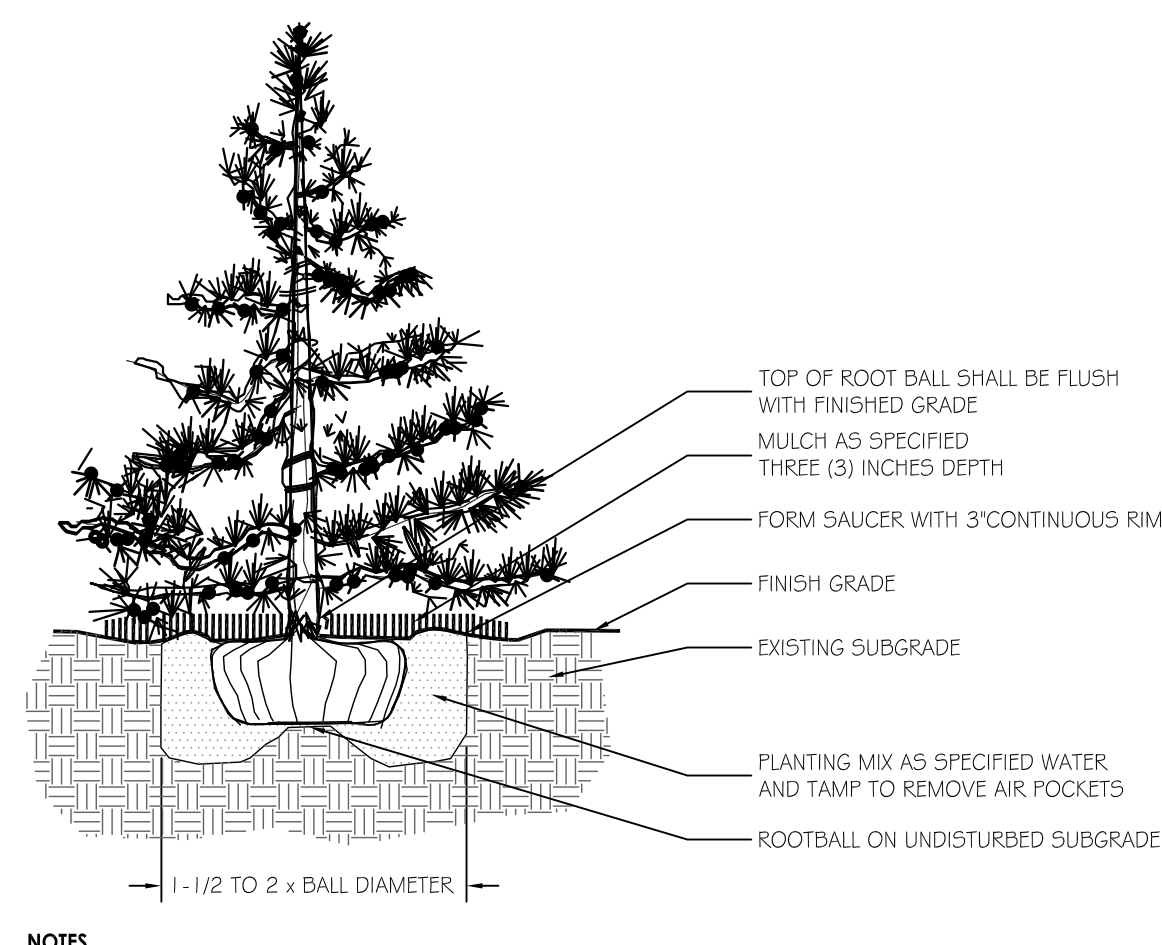

NOTES
 1. DO NOT STAKE TREES UNLESS SOIL IS VERY SANDY OR AS DIRECTED BY LANDSCAPE ARCHITECT.
 2. PLANT SO THAT TOP OF ROOT BALL IS EVEN WITH THE FINISHED GRADE.
 3. PAINT ALL CUTS OVER 1 INCH DIAMETER.

2 EVERGREEN TREE
 SCALE: 1/2" = 1'-0"

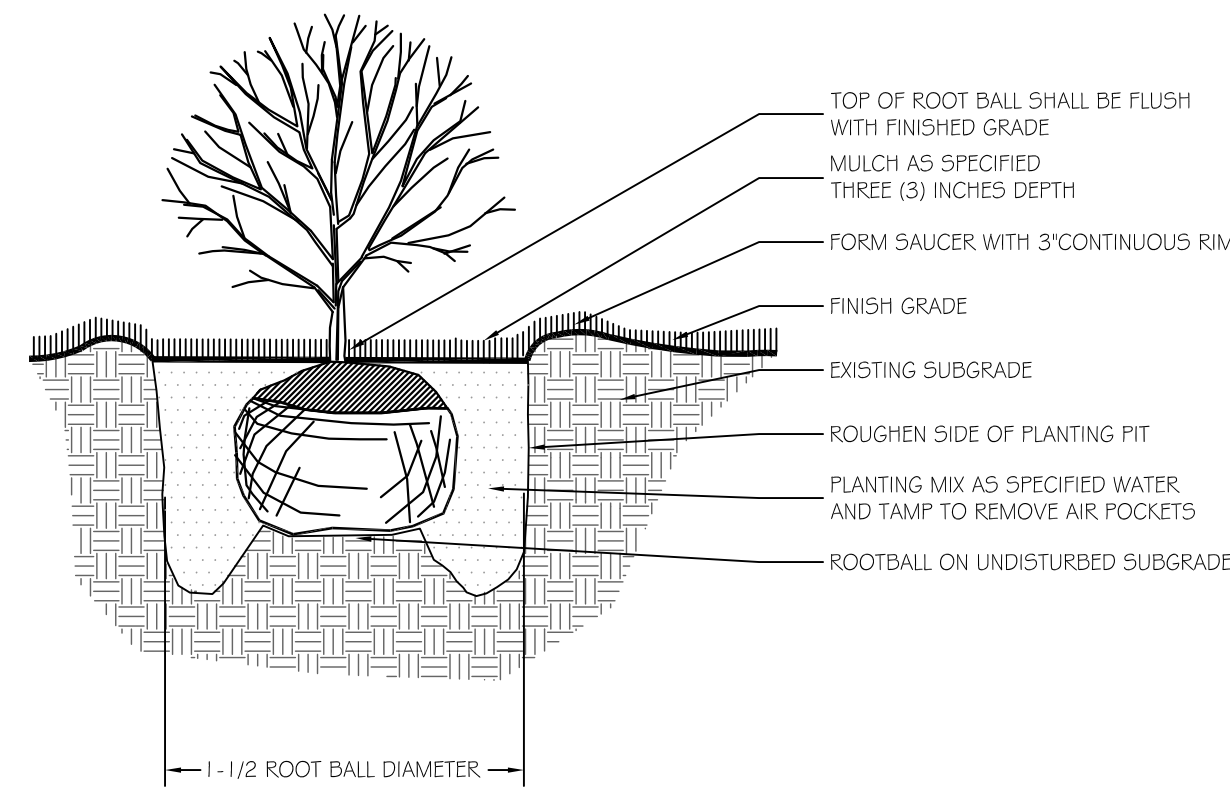

NOTES
 1. REMOVE ALL DEAD WOOD. DO NOT REMOVE ANY OTHER VEGETATION.
 2. REMOVE ALL CONTAINERS AND PROTECTION DEVICES PRIOR TO PLANTING.
 3. REMOVE BURLAP FROM TOP ONE THIRD OF ROOT BALL.

3 SHRUB BALLED & BURLAPPED
 SCALE: 1/2" = 1'-0"

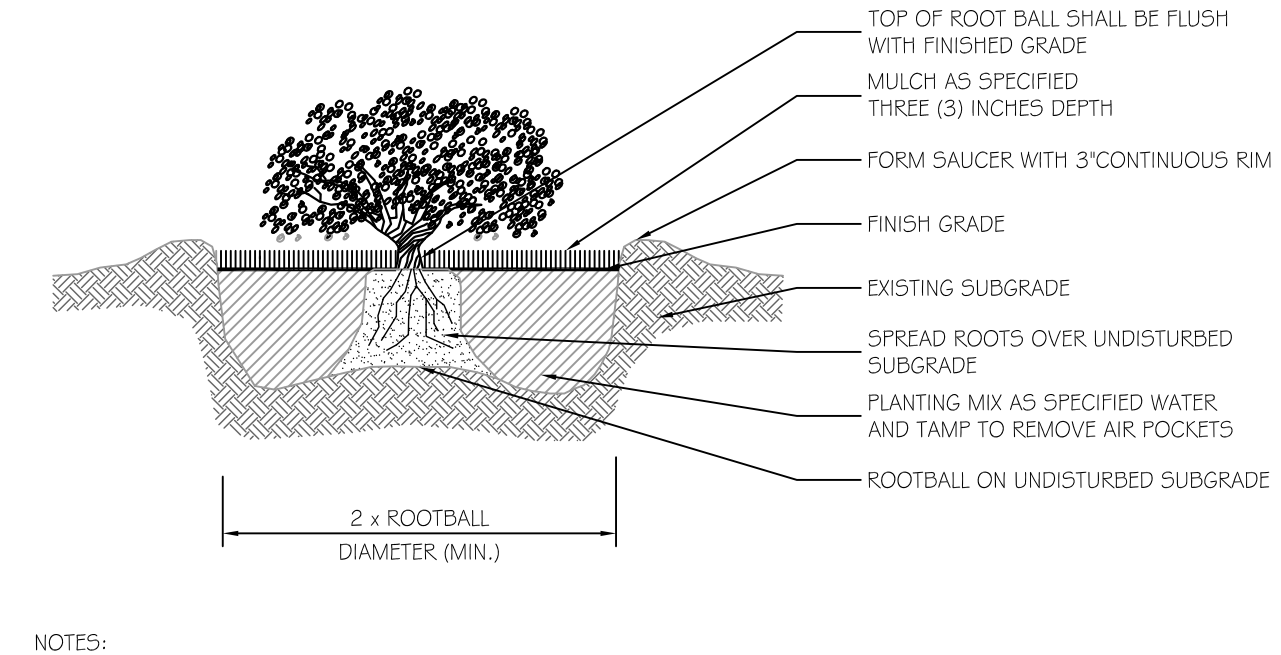

NOTES
 1. REMOVE ALL DEAD WOOD. DO NOT REMOVE ANY OTHER VEGETATION.
 2. REMOVE ALL CONTAINERS AND PROTECTION DEVICES PRIOR TO PLANTING.
 3. GENTLY HAND LOOSEN SOIL FROM AROUND ROOTBALL WITHOUT SEVERING MAIN ROOTS.

4 SHRUB CONTAINER GROWN
 SCALE: 1/2" = 1'-0"

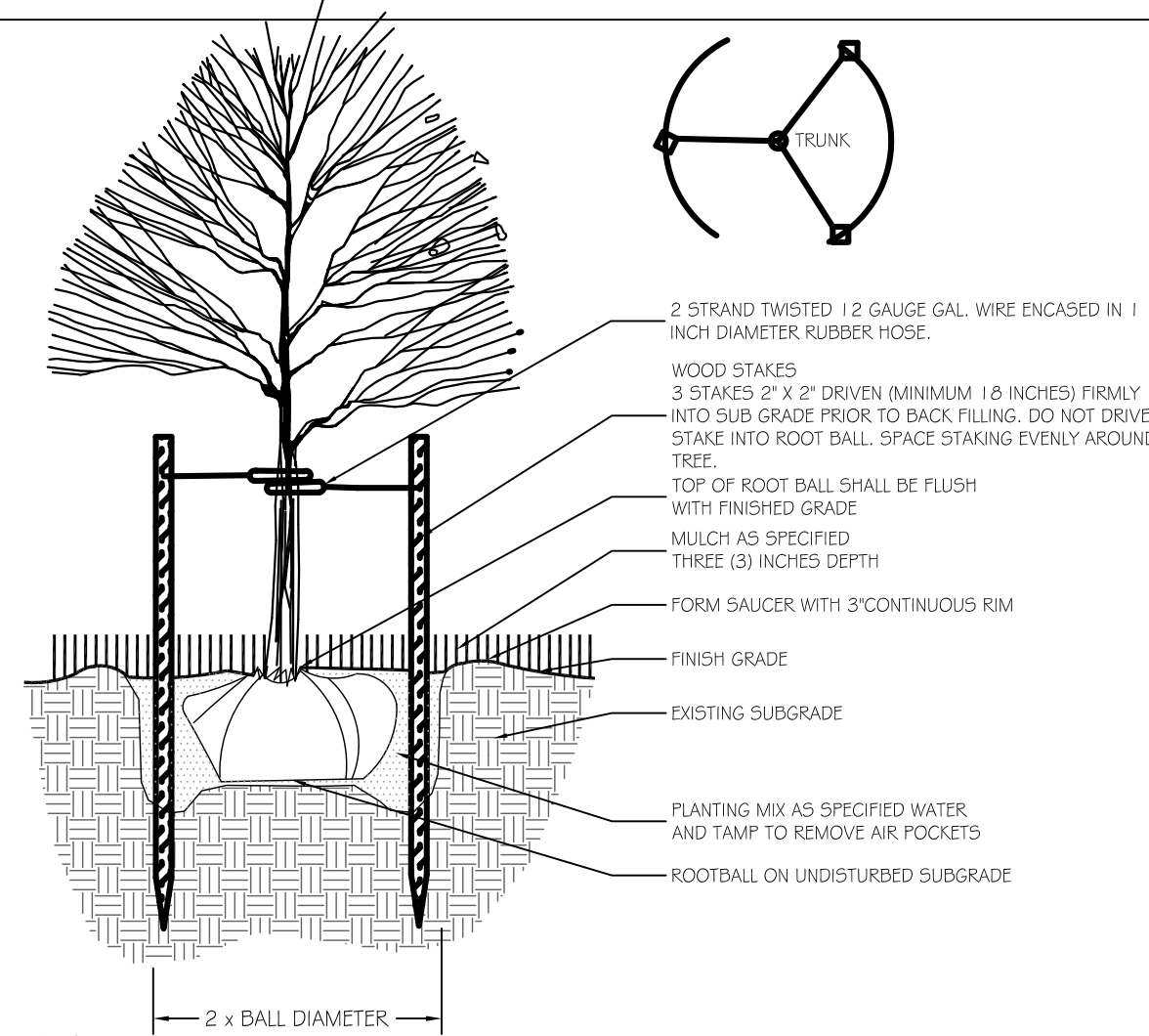

NOTES
 1. PLANT SO THAT TOP OF ROOT BALL IS EVEN WITH THE FINISHED GRADE
 2. REMOVE ALL CONTAINERS AND BASKETS ENTIRELY FROM ROOT BALL
 3. REMOVE BURLAP FROM TOP ONE THIRD OF ROOT BALL
 4. STAKE TO MAIN BRANCHES AS NECESSARY FOR FIRM SUPPORT
 5. STAKES SHALL NOT TOUCH OR RUB ADJACENT TRUNKS OR BRANCHES
 6. PAINT ALL CUTS OVER ONE INCH DIA.

5 GROUND COVER
 SCALE: 1/2" = 1'-0"

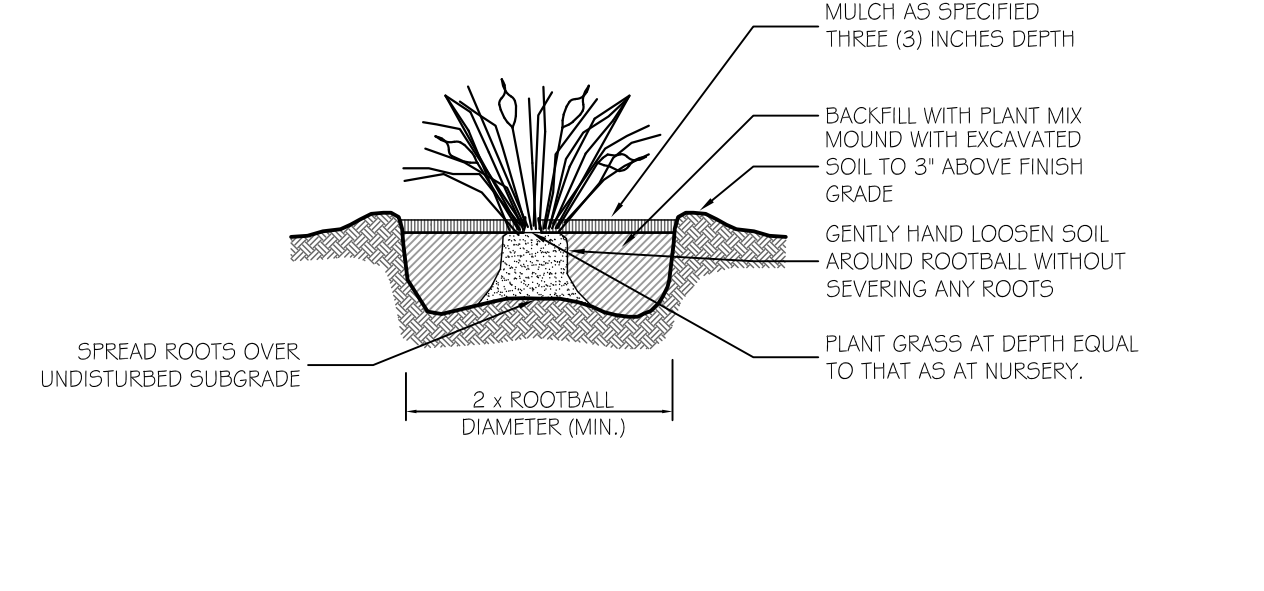

6 ORNAMENTAL GRASS PLANTING
 SCALE: 1/2" = 1'-0"

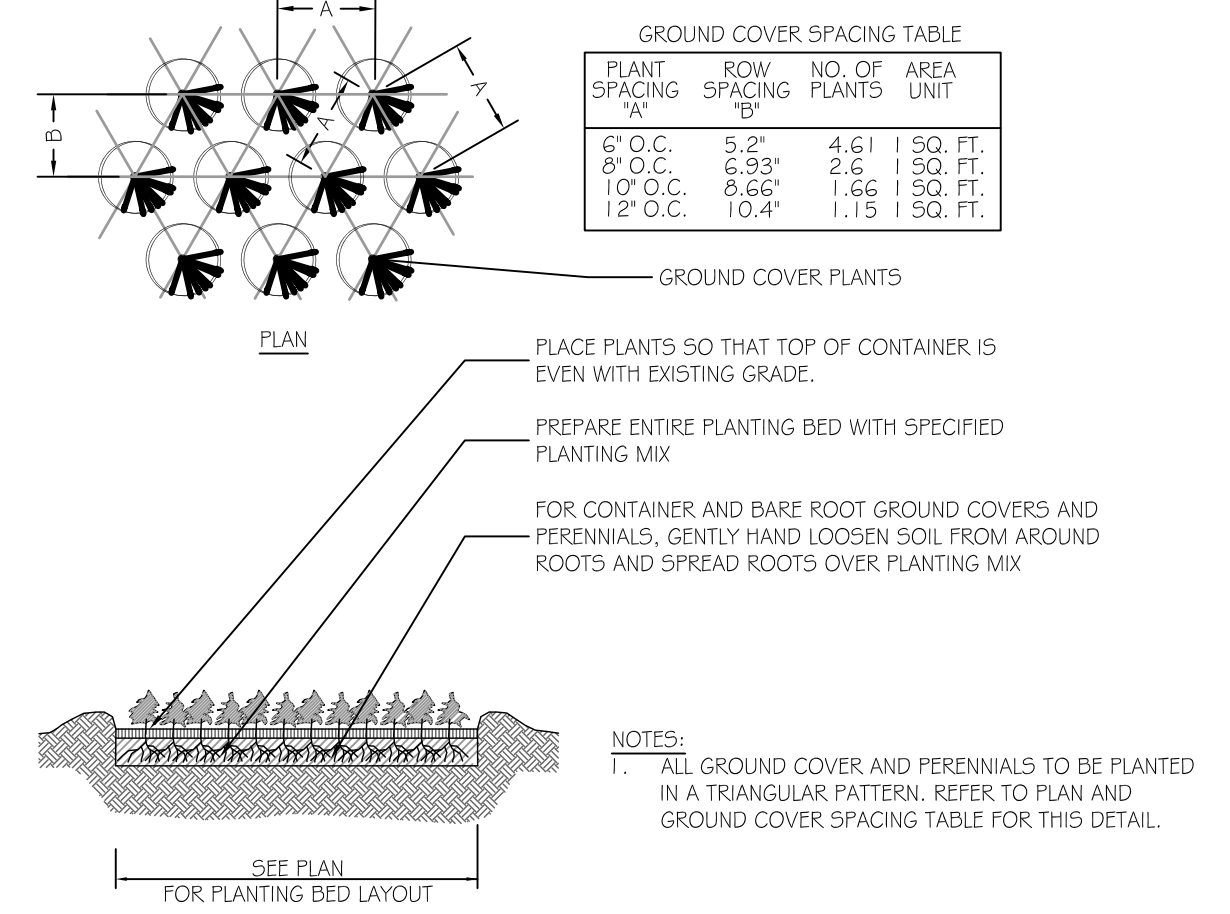

7 PERENNIAL PLANTING DETAIL
 SCALE: 1/2" = 1'-0"

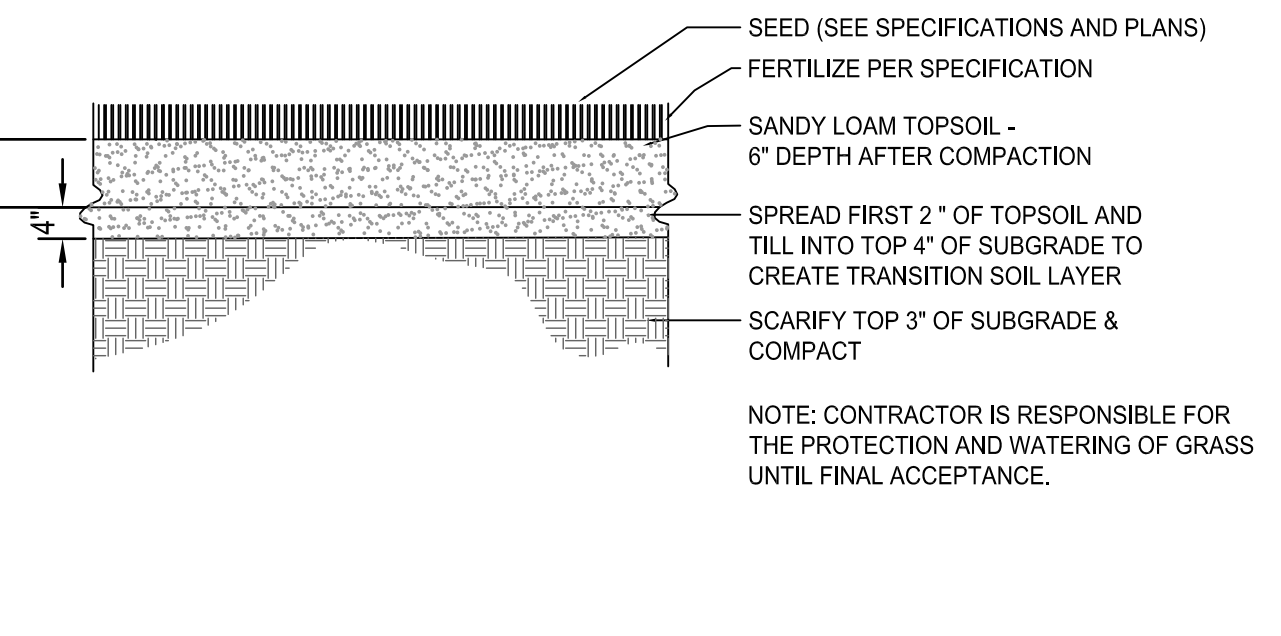

8 LOAM & SEED DETAIL
 SCALE: 1/2" = 1'-0"

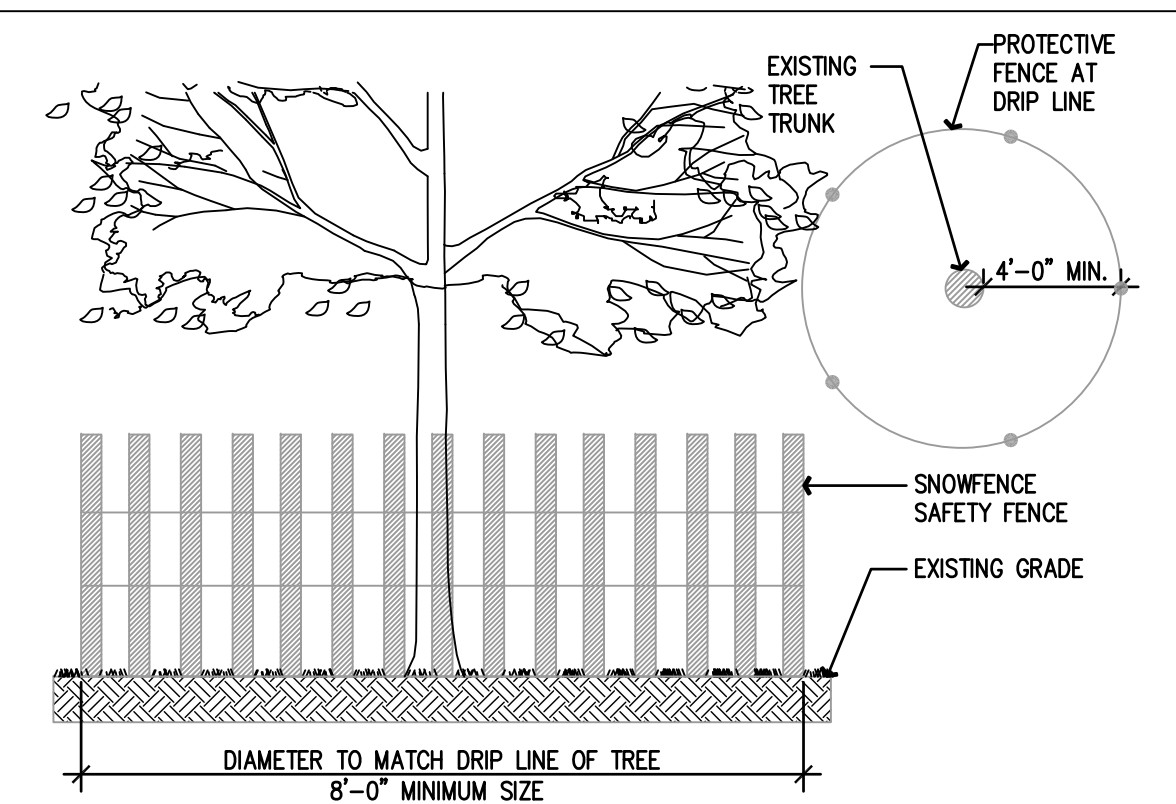

NOTES
 1.) PROTECTIVE FENCE TO REMAIN UNTIL CONSTRUCTION IS COMPLETE
 2.) ANY EXCAVATING WITHIN DRIPLINE MUST BE APPROVED BY L.A. AND MUST BE HAND-DUG. CONTRACTOR SHALL NOT CUT ANY ROOTS AND/OR BRANCHES UNLESS APPROVED BY L.A.
 3.) ROOTS GREATER THAN 1" SHALL NOT BE CUT UNLESS OTHERWISE APPROVED BY THE L.A.
 4.) STOCKPILED MATERIALS OR UNNECESSARY VEHICULAR TRAFFIC SHALL NOT BE ALLOWED OVER ANY TREE ROOT SYSTEM
 5.) ALL EXPOSED ROOT STUBS AND ROOTS ARE TO BE BACK FILLED WITH APPROVED TOPSOIL
 6.) THE COST OF TREE BARRICADES AND MAINTENANCE THROUGH OUT PROJECT SHALL BE INCLUDED IN CONTRACT

9 TREE PROTECTION FENCING TYP
 SCALE: 1/2" = 1'-0"

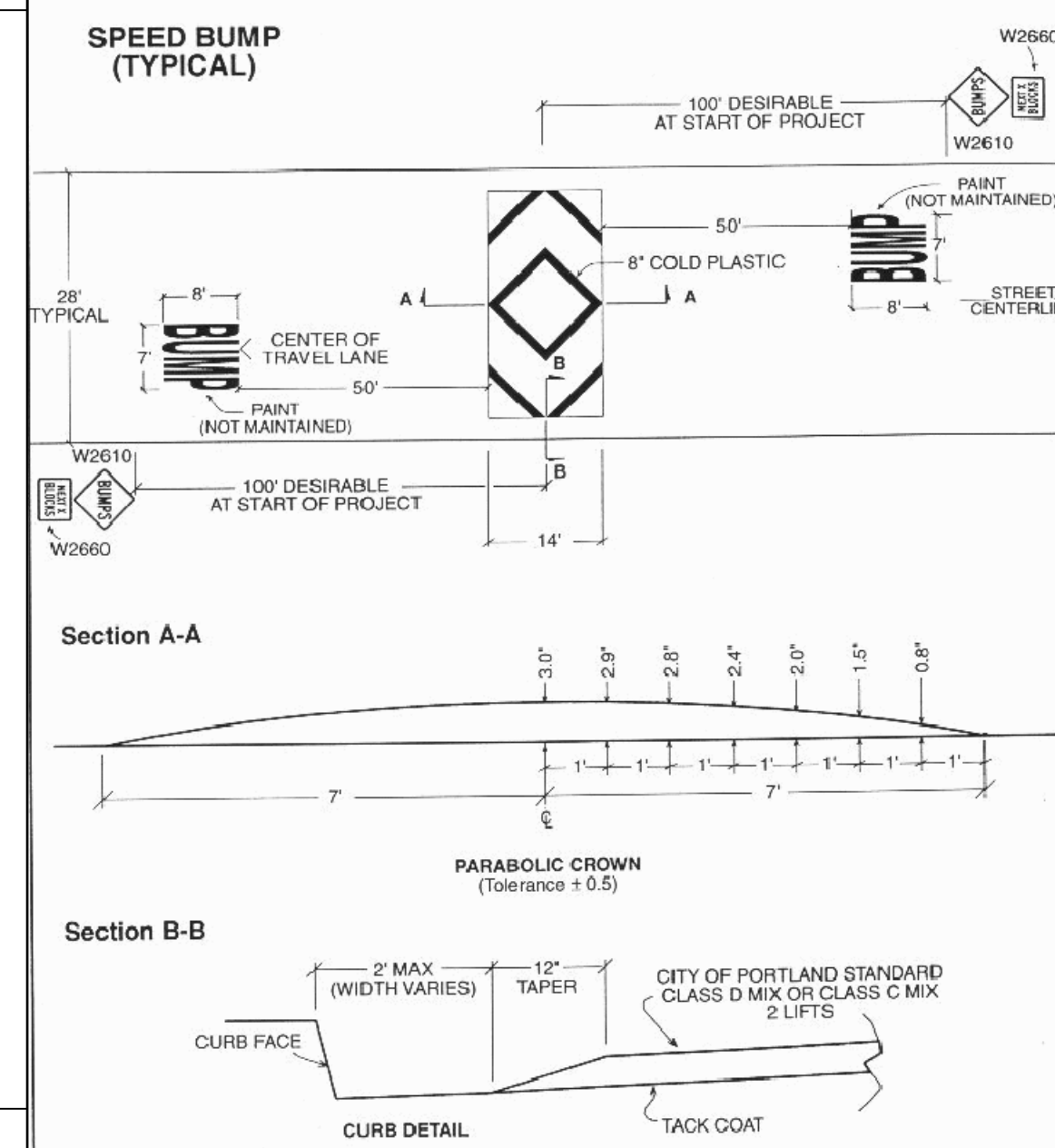

10 SPEED HUMP - BITUMINOUS
 SCALE: 1/2" = 1'-0"

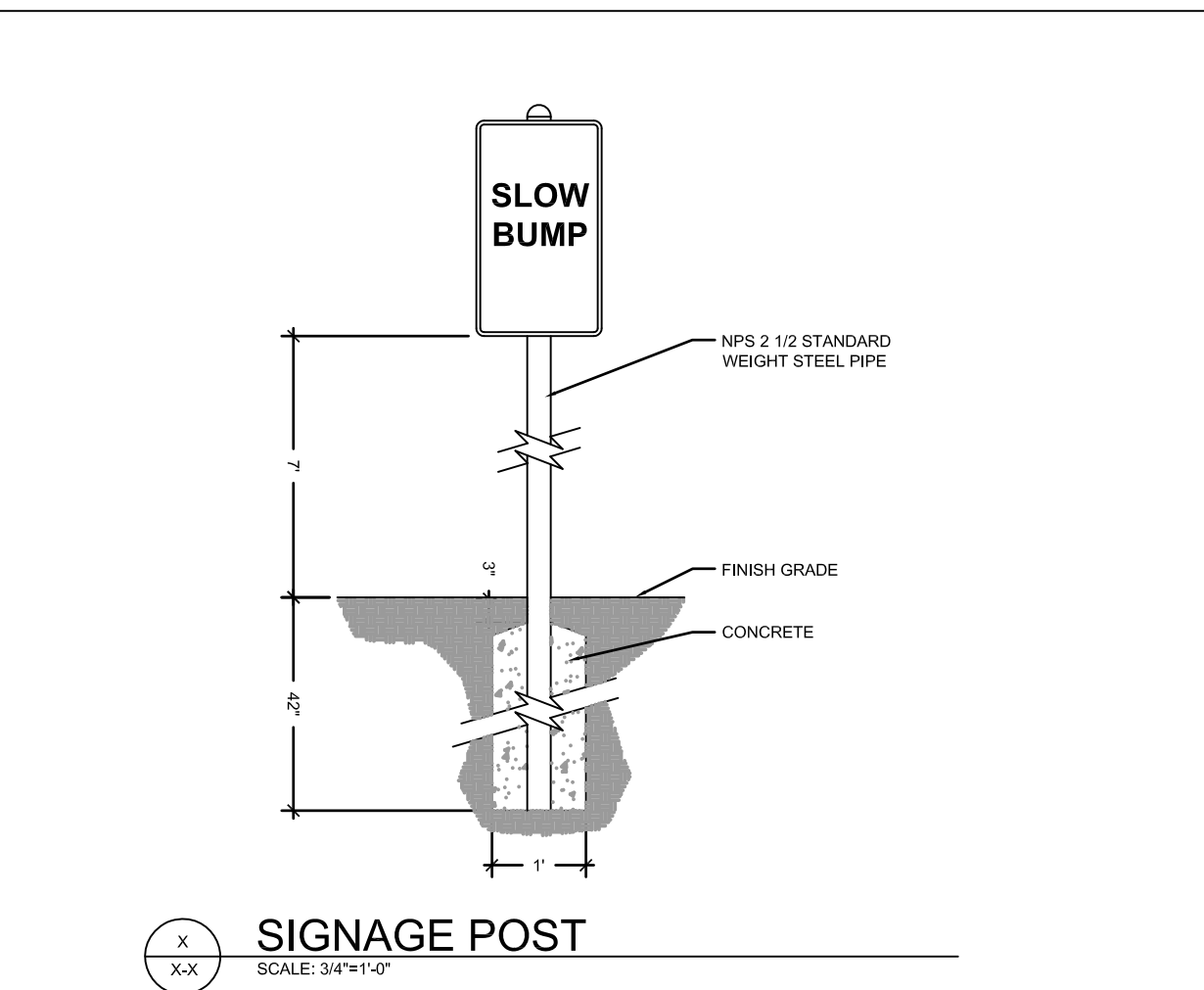

11 SPEED HUMP WARNING SIGN
 SCALE: 1/2" = 1'-0"

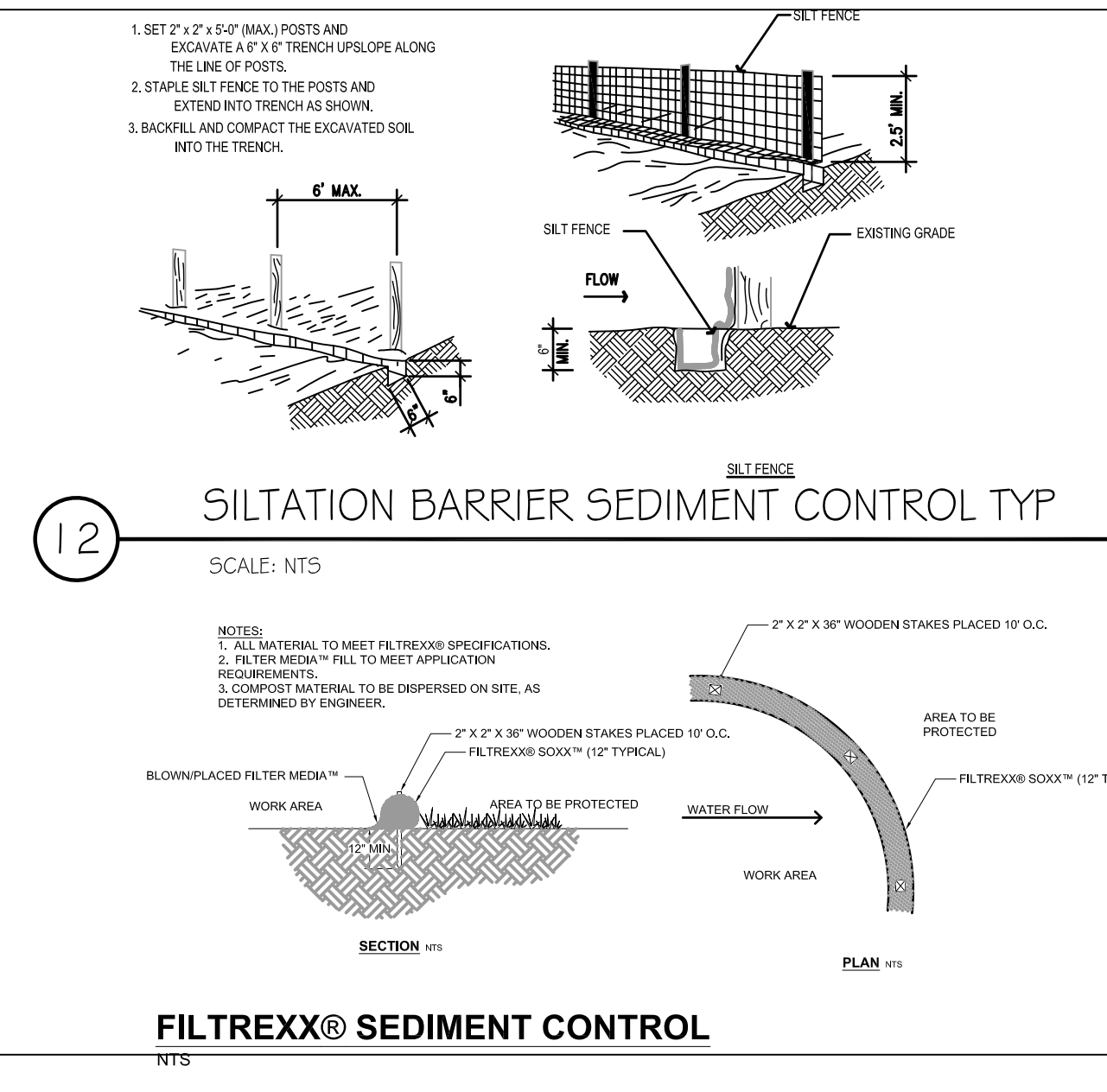

12 SEDIMENT CONTROL ALTERNATIVE TYP
 SCALE: NTS

BID SET DOCUMENTS

**EAST PROVIDENCE SENIOR CTR
 610 WATERMAN AVENUE
 EAST PROVIDENCE, RI**

COPYRIGHT 2022 LANDSCAPE ELEMENTS, LLC. ALL RIGHTS RESERVED. NO PART OF THIS PUBLICATION MAY BE REPRODUCED, STORED IN A RETRIEVAL SYSTEM OR TRANSMITTED BY ANY MEANS, ELECTRONIC, MECHANICAL, PHOTOCOPYING, RECORDING, OR OTHERWISE WITHOUT THE PRIOR WRITTEN PERMISSION OF LANDSCAPE ELEMENTS LLC.

NOTES
 1. THESE DRAWINGS ARE THE PROPERTY OF THE LANDSCAPE ARCHITECT, ELINA M. PASCARELLA, B.L.A., A.S.L.A. AND LANDSCAPE ELEMENTS, LLC. THEY HAVE BEEN PREPARED FOR THE OWNER FOR THIS PROJECT AT HIS SITE. THESE DRAWINGS ARE NOT TO BE USED FOR ANY OTHER PURPOSE, LOCATION, OR OWNER WITHOUT WRITTEN CONSENT OF THIS OWNER AND/OR THE LANDSCAPE ARCHITECT.
 2. LANDSCAPE ELEMENTS LLC ASSUMES NO RESPONSIBILITY OR LIABILITY IF THE WORK IS NOT INSTALLED AS PER THE PLANS OR IF FIELD CHANGES ARE MADE WITHOUT THE KNOWLEDGE AND APPROVAL OF THIS LANDSCAPE ARCHITECT.

REVISIONS

STAMPS



DATE: APRIL 12TH, 2022
 JOB NO. 21-027-EPSRCTR
 DRAWN BY: EMP
 CHECKED BY: EMP/AA

**DRAWING TITLE:
 DETAILS**

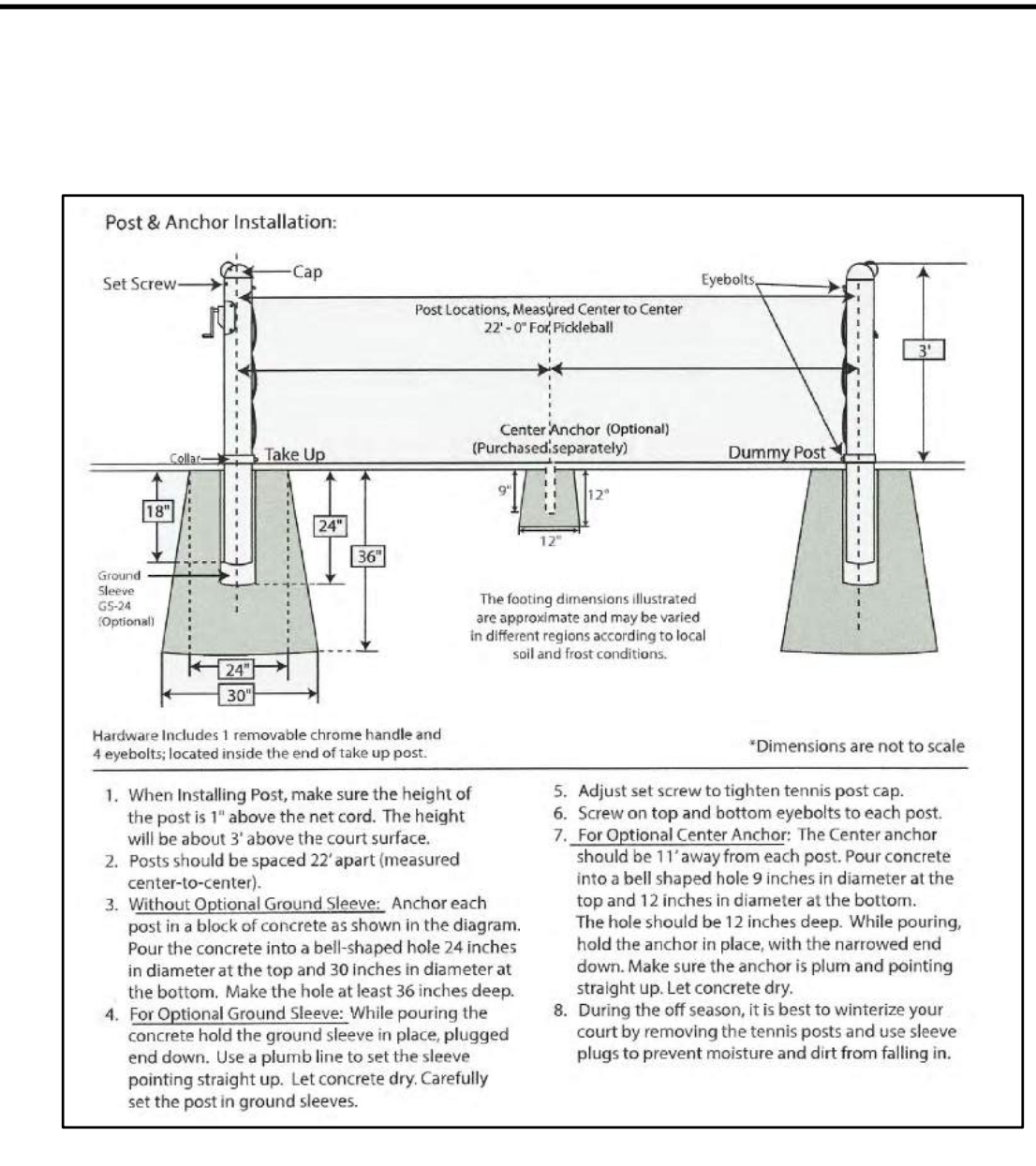

4 PICKLE BALL NET
 SCALE: NTS

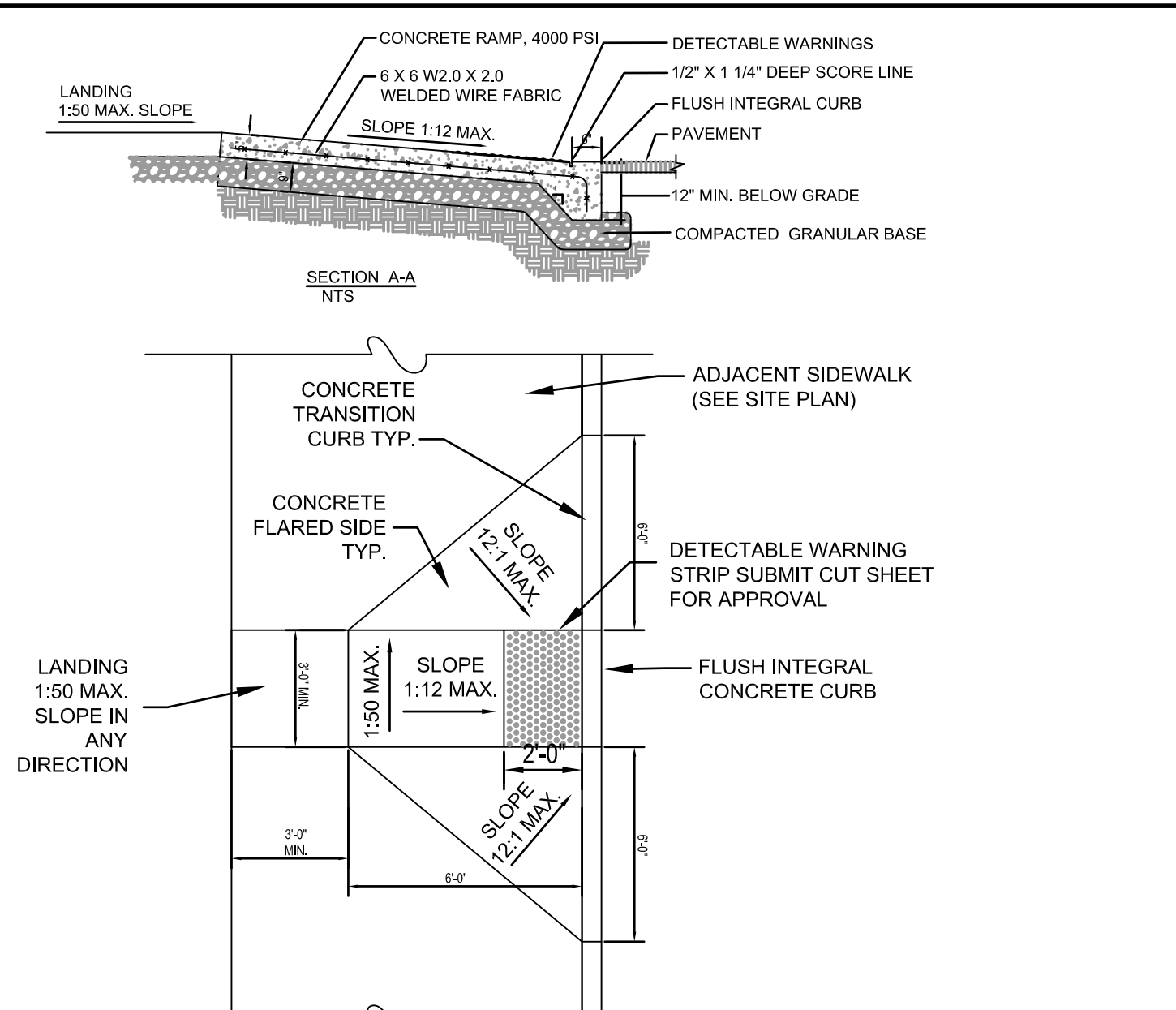

3 DETECTABLE WARNING STRIP
 SCALE: NTS

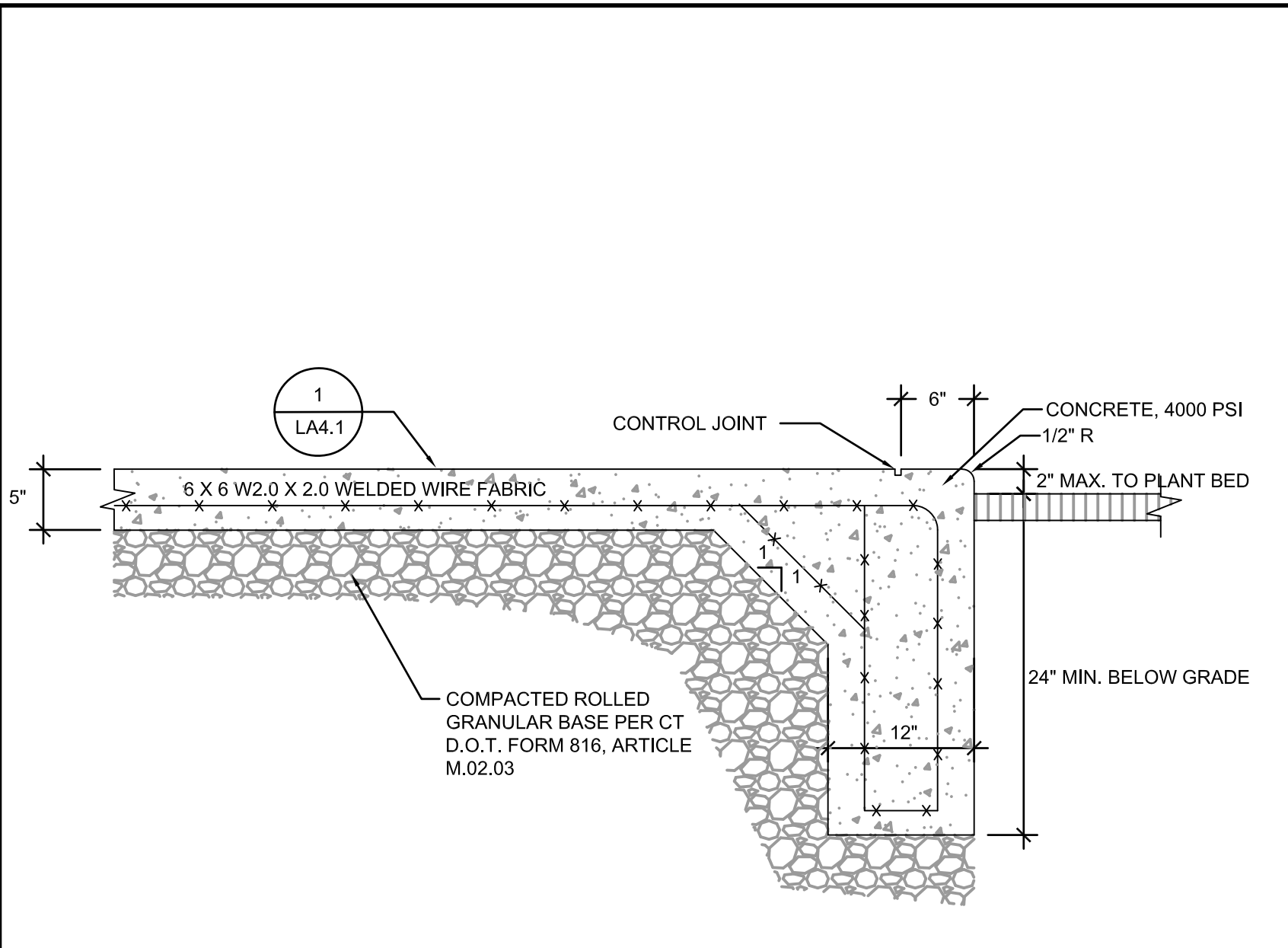

2 CONCRETE TERRACE PVMT TYP
 SCALE: 1" = 1'-0"

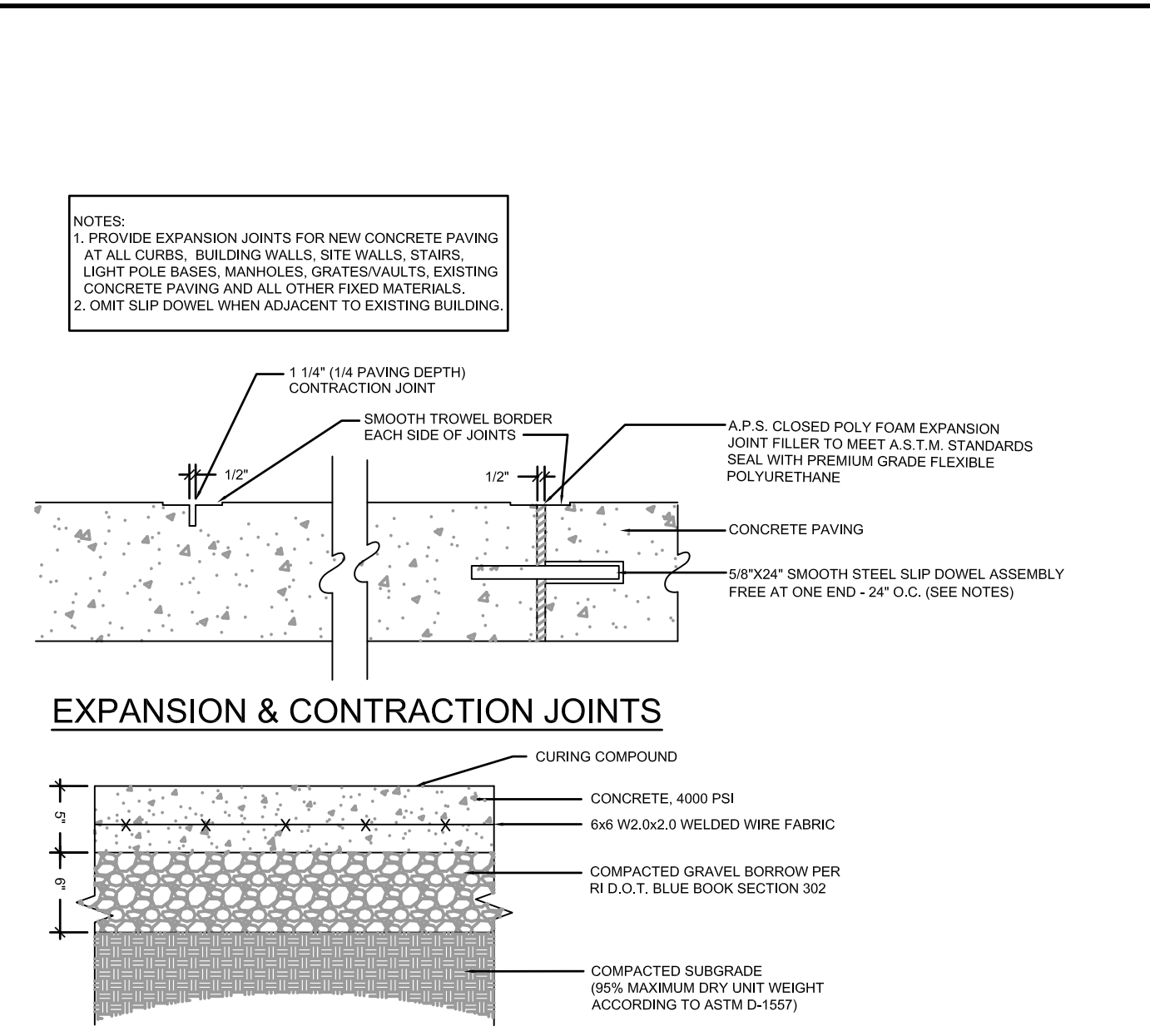

1 CONCRETE WALK TYP
 SCALE: 1" = 1'-0"

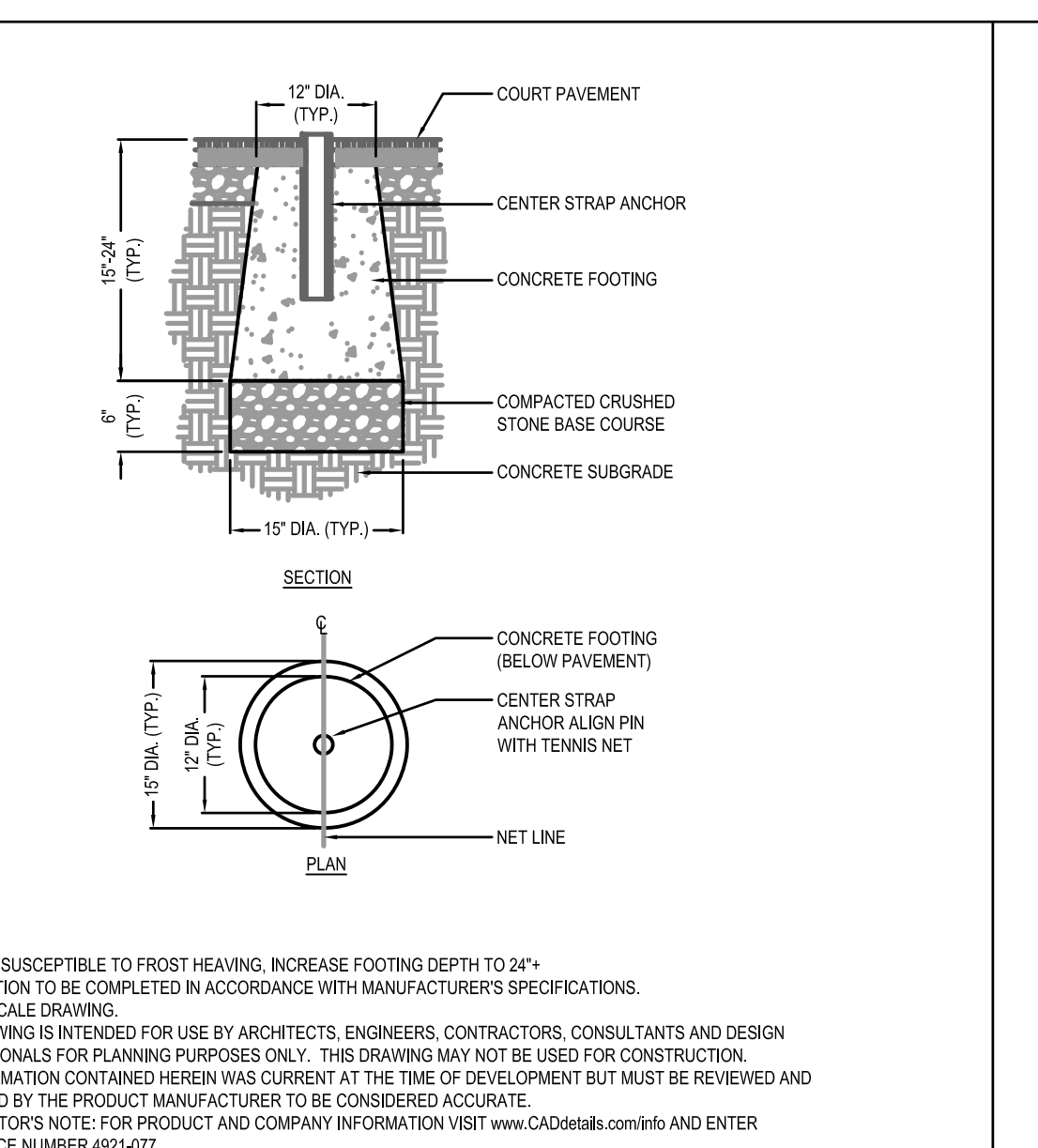

8 NET ANCHOR CTR COURT TYP
 SCALE: 1/2" = 1'-0"

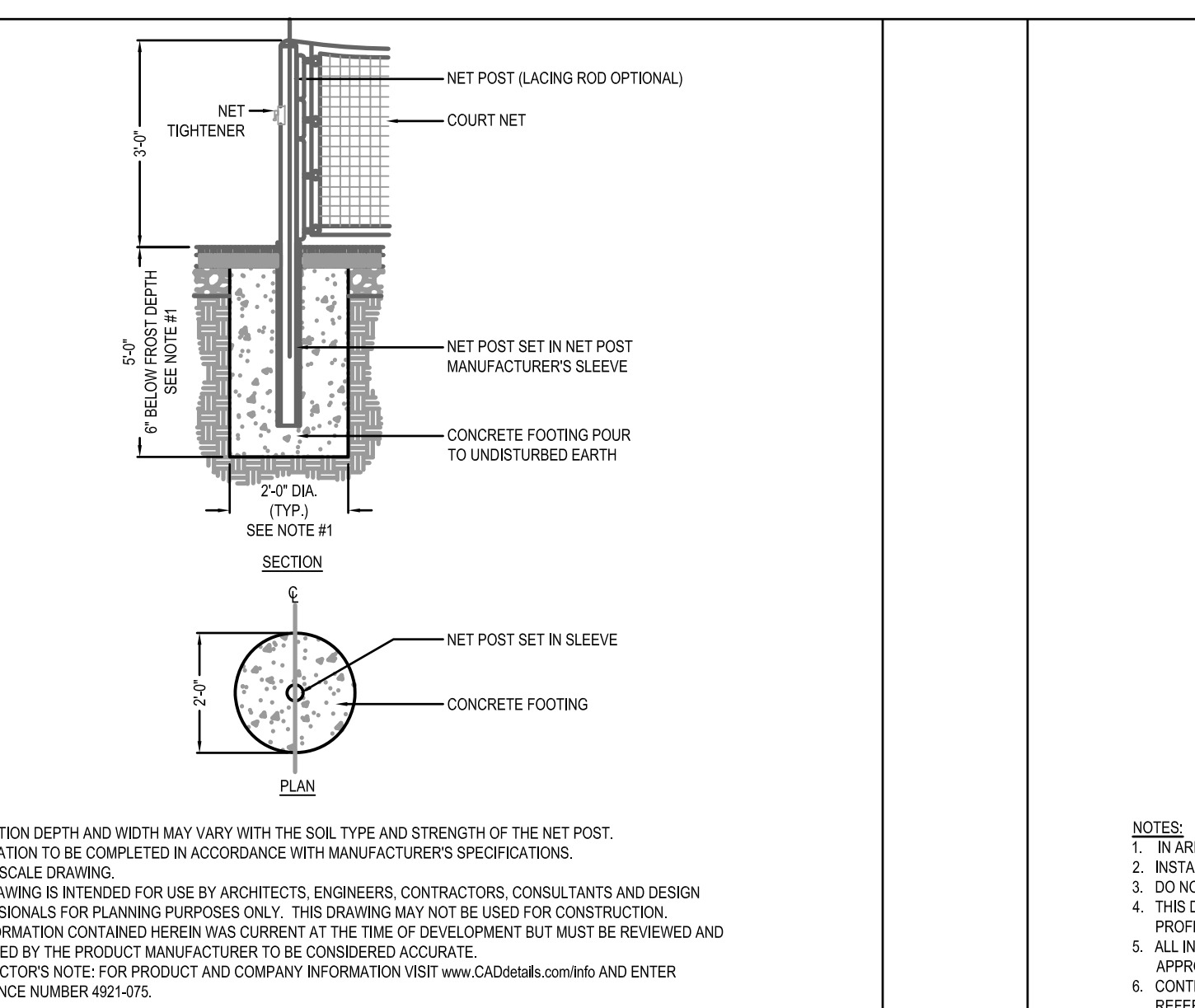

7 PICKLE BALL COURT NET POST
 SCALE: 1/2" = 1'-0"

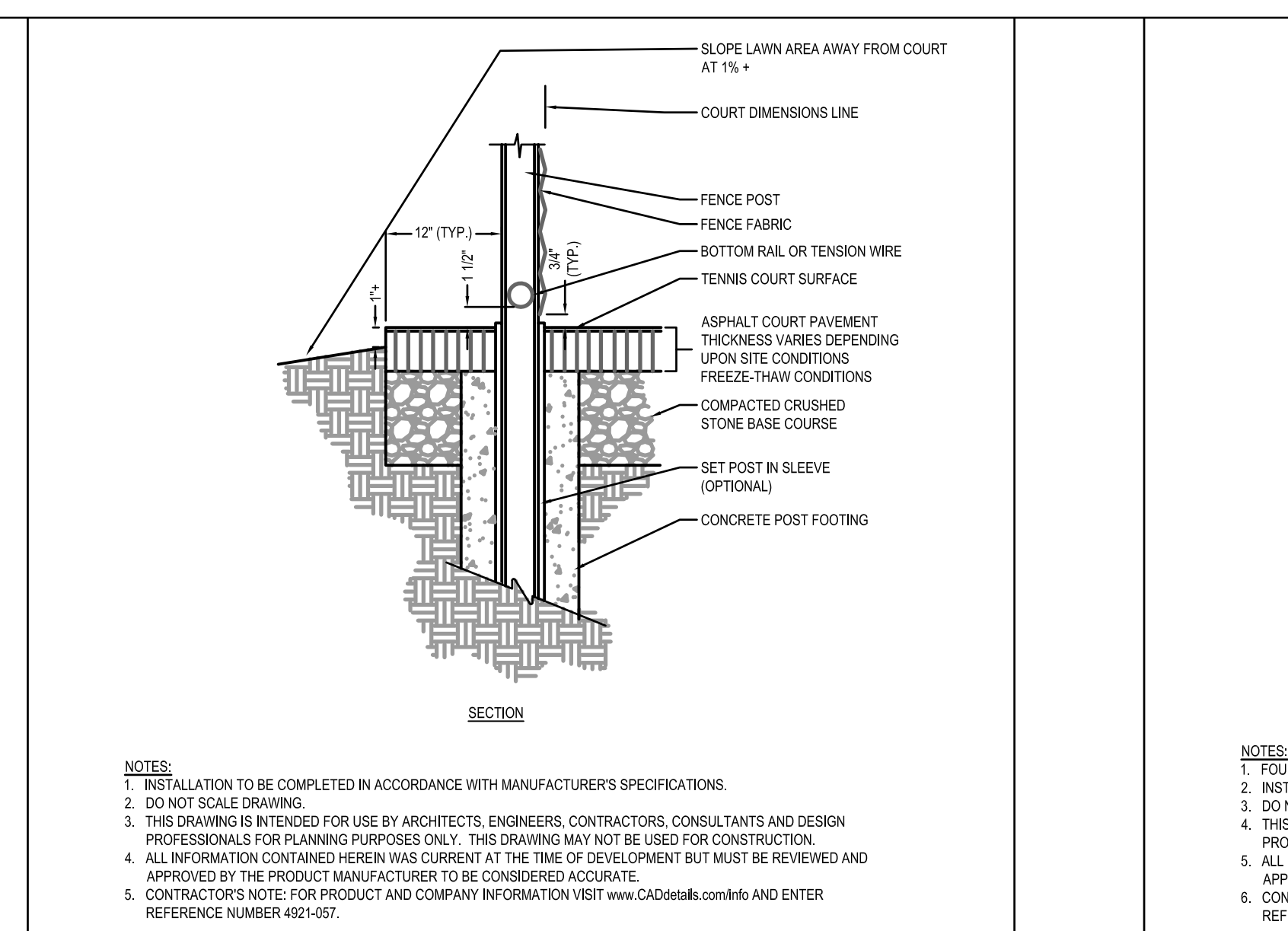

6 PICKLE BALL COURT SURFACE - EDGE
 SCALE: 1/2" = 1'-0"

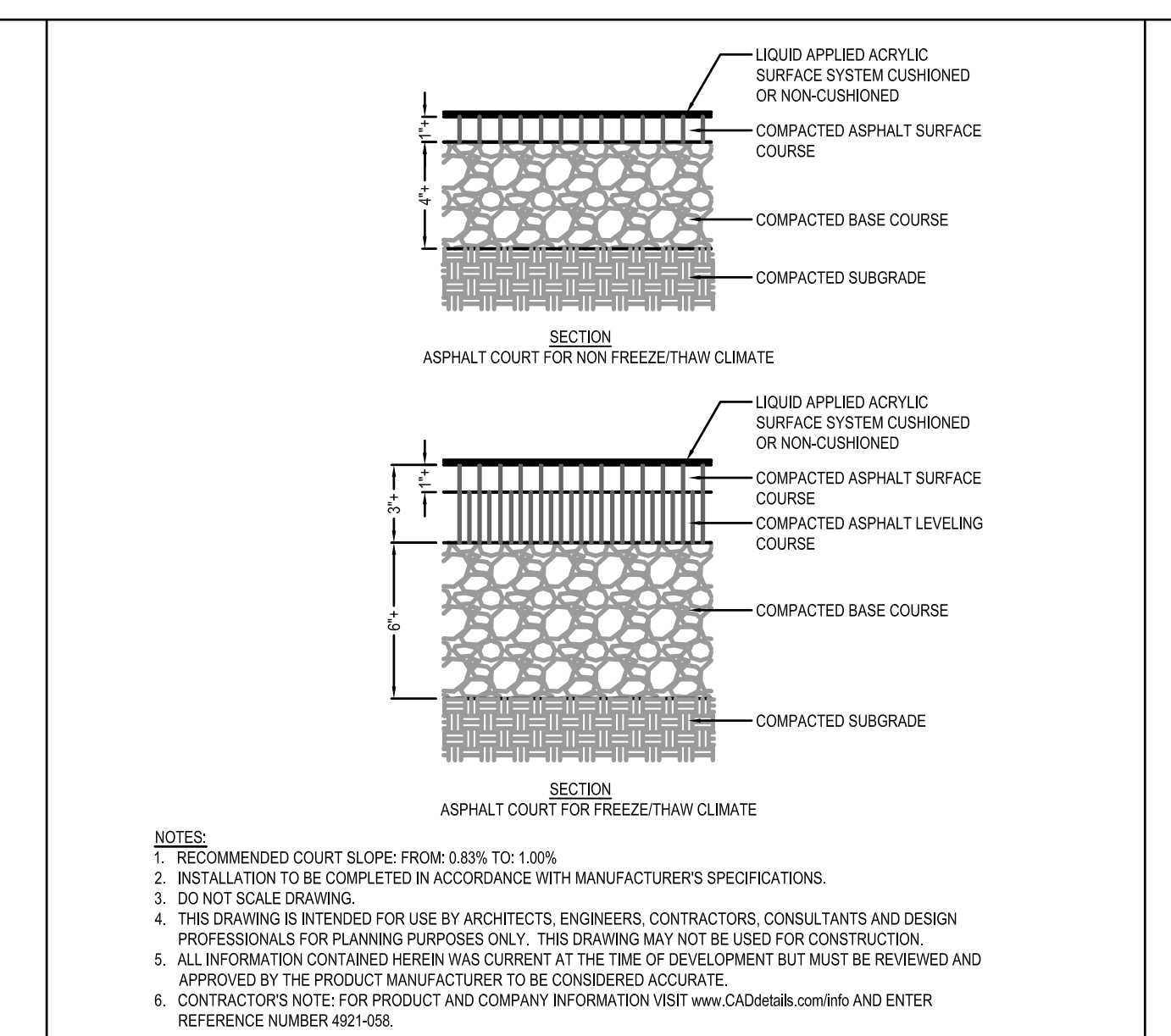

5 PICKLE BALL COURT SURFACING
 SCALE: 1-1/2" = 1'-0"

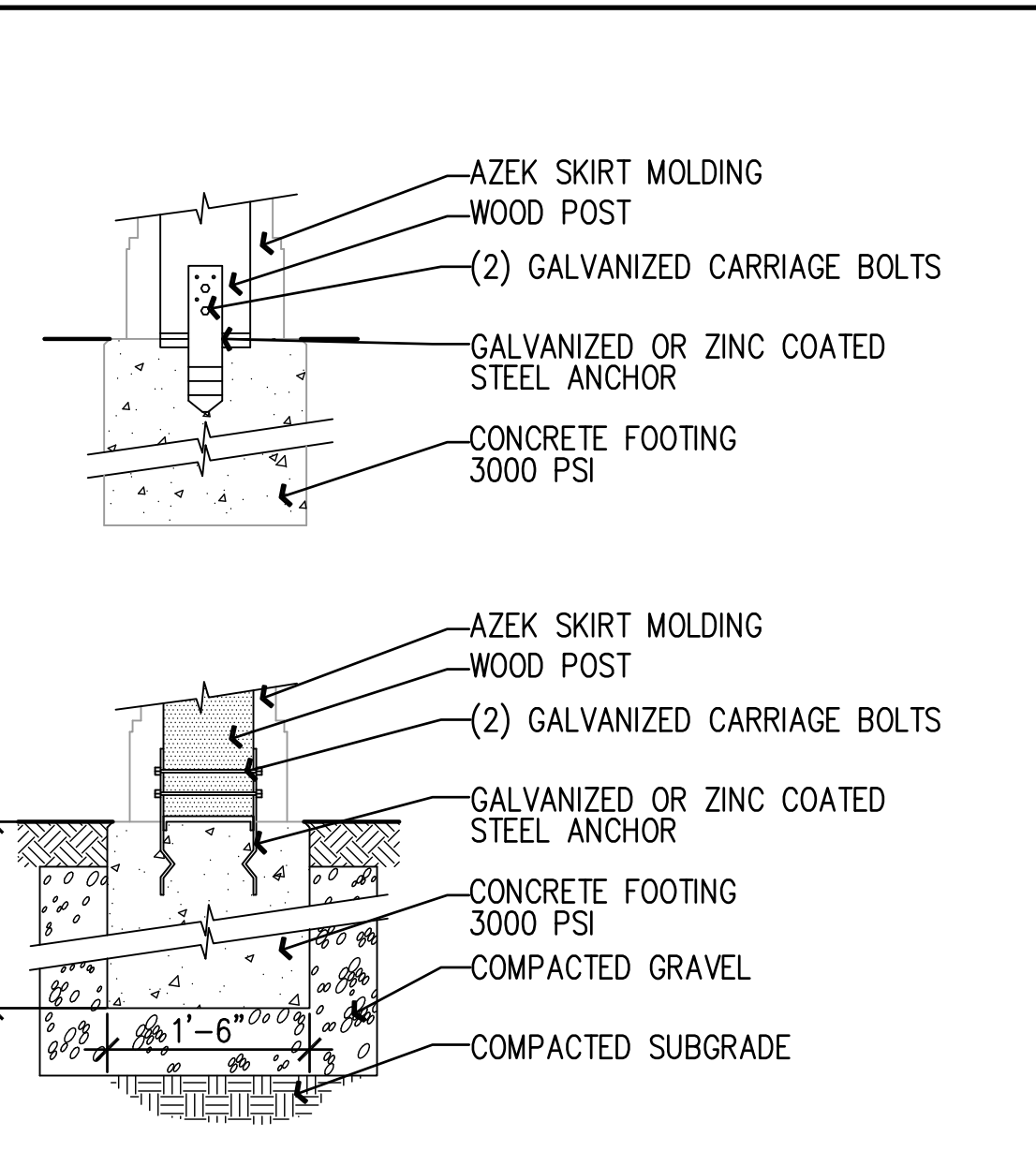

12 WOOD GAZEBO ANCHOR TO CONCRETE
 SCALE: 1/2" = 1'-0"

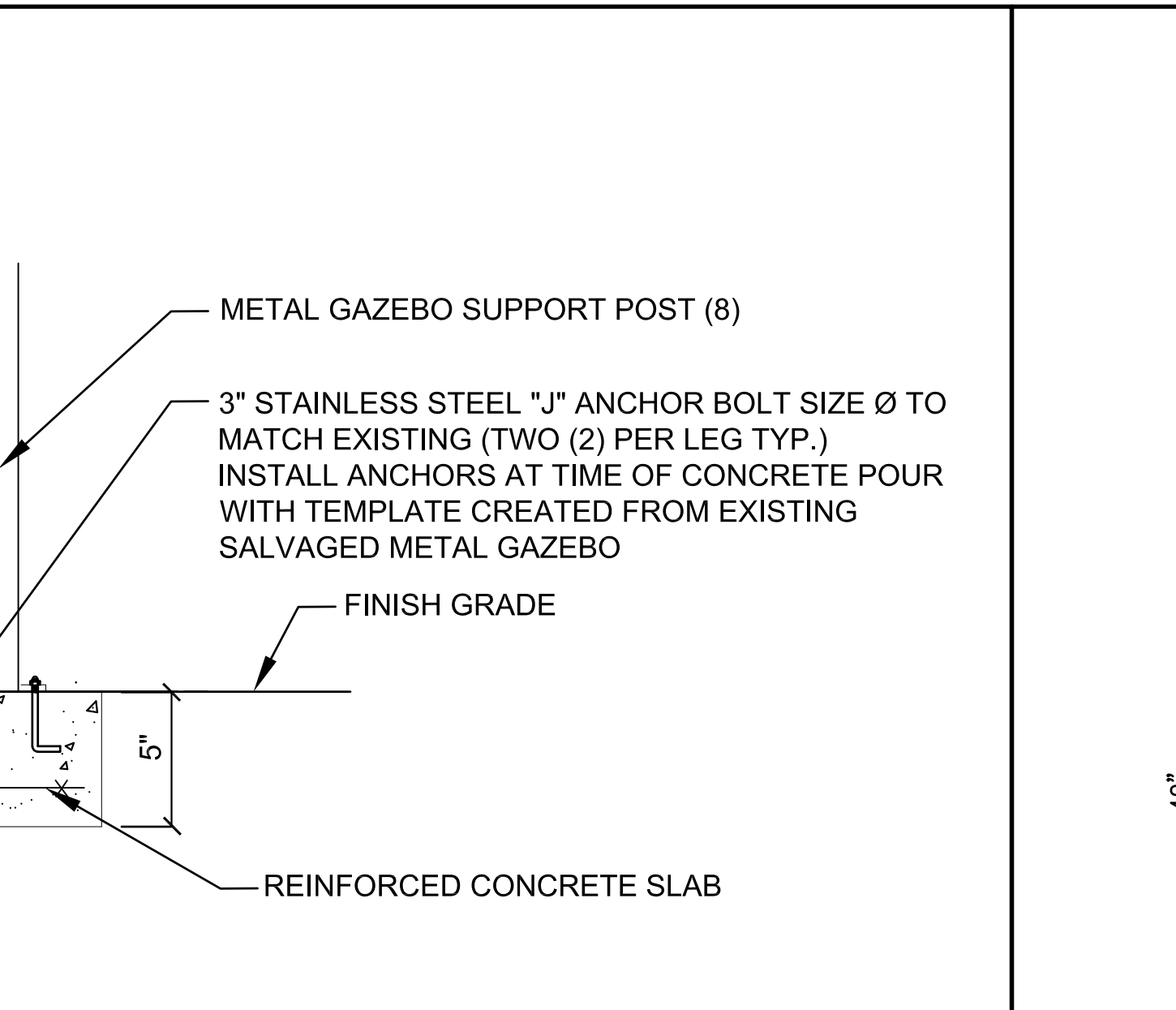

11 METAL GAZEBO ANCHOR TO CONCRETE
 SCALE: 1/2" = 1'-0"

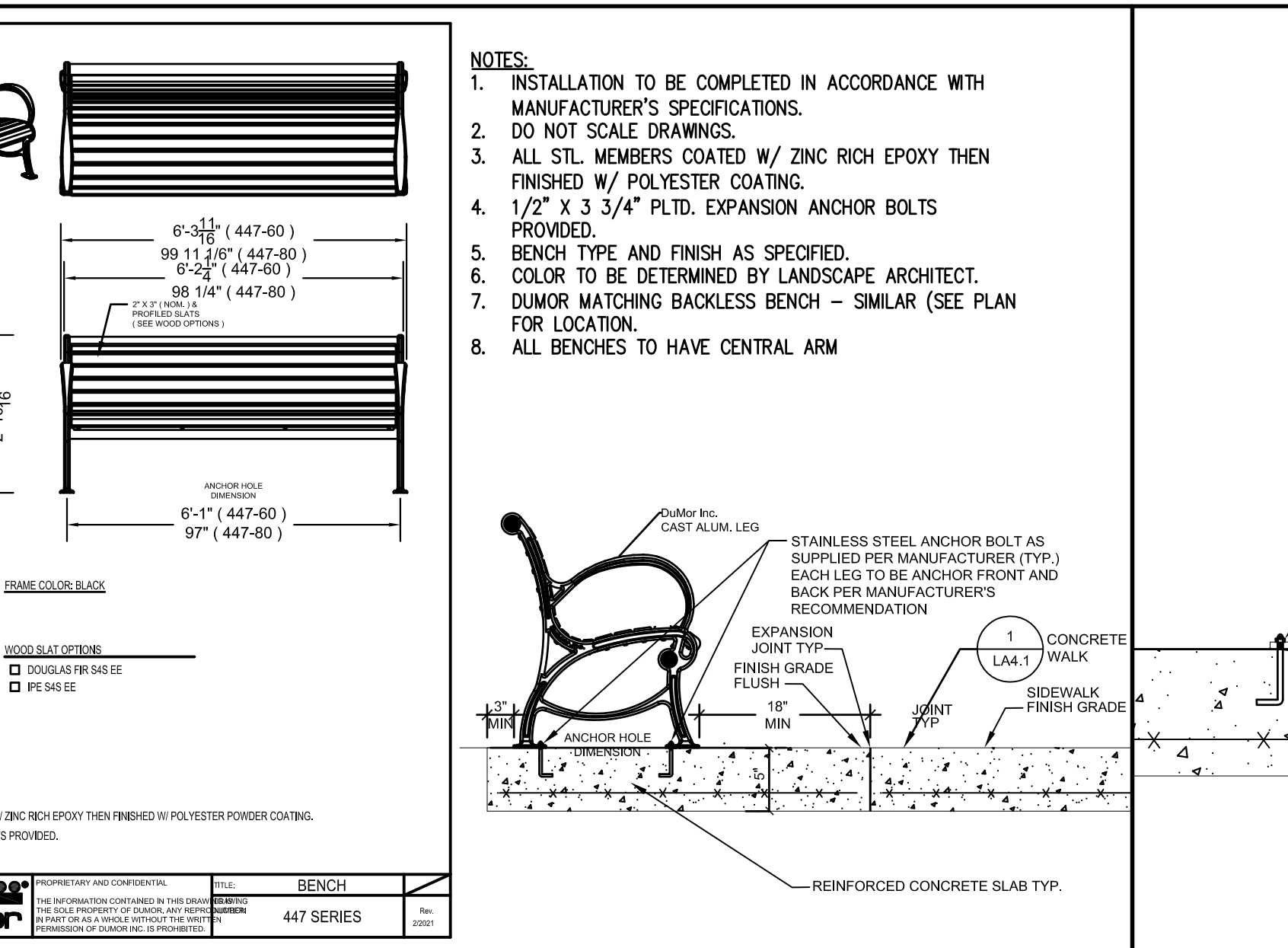

10 BENCH TYP
 SCALE: 1/2" = 1'-0"

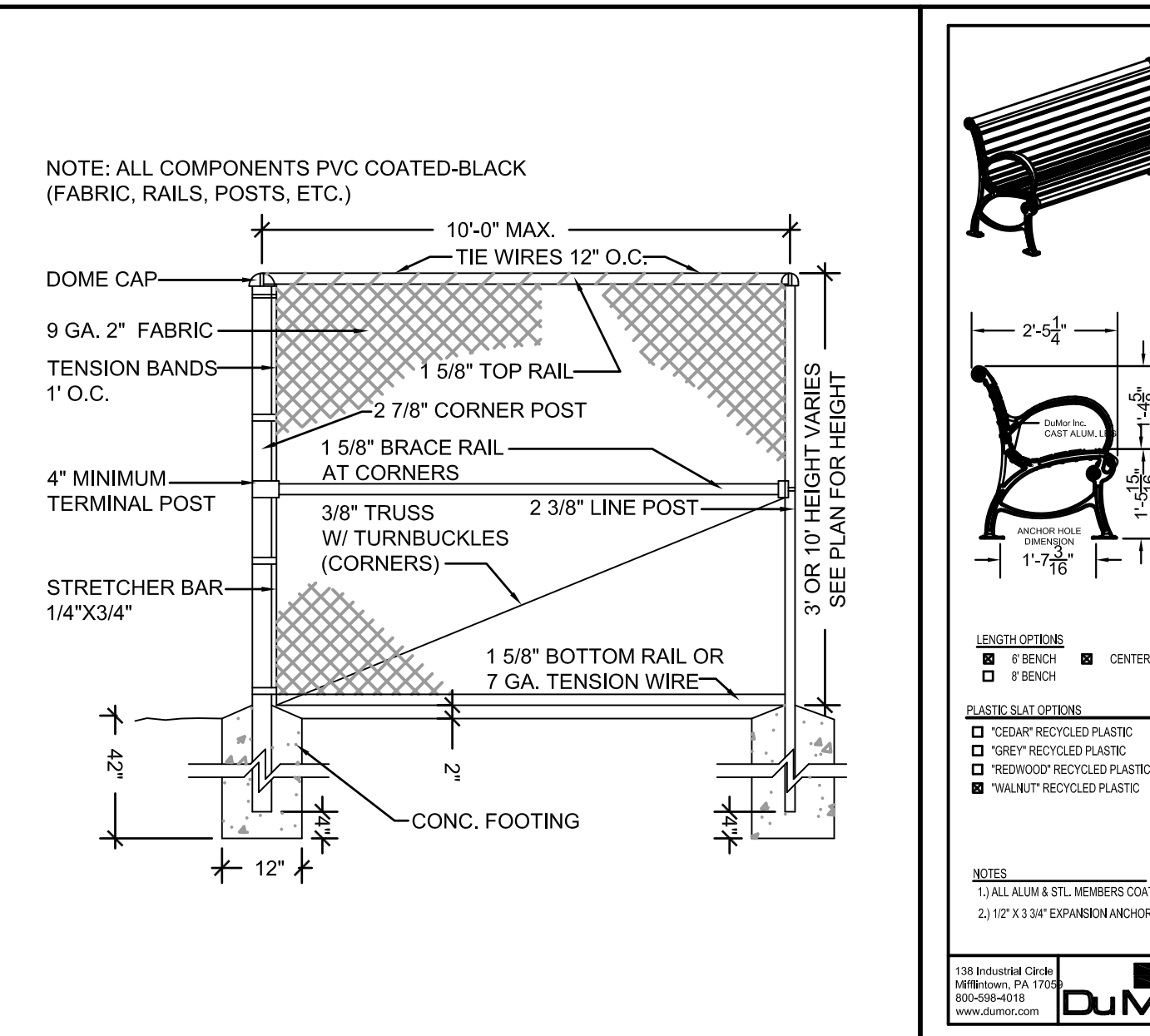

9 PICKLE BALL COURT FENCE TYP.
 SCALE: 1/2" = 1'-0"