

SECOND LEVEL

NOTE: MINIMUM CEILING HEIGHT 24FT

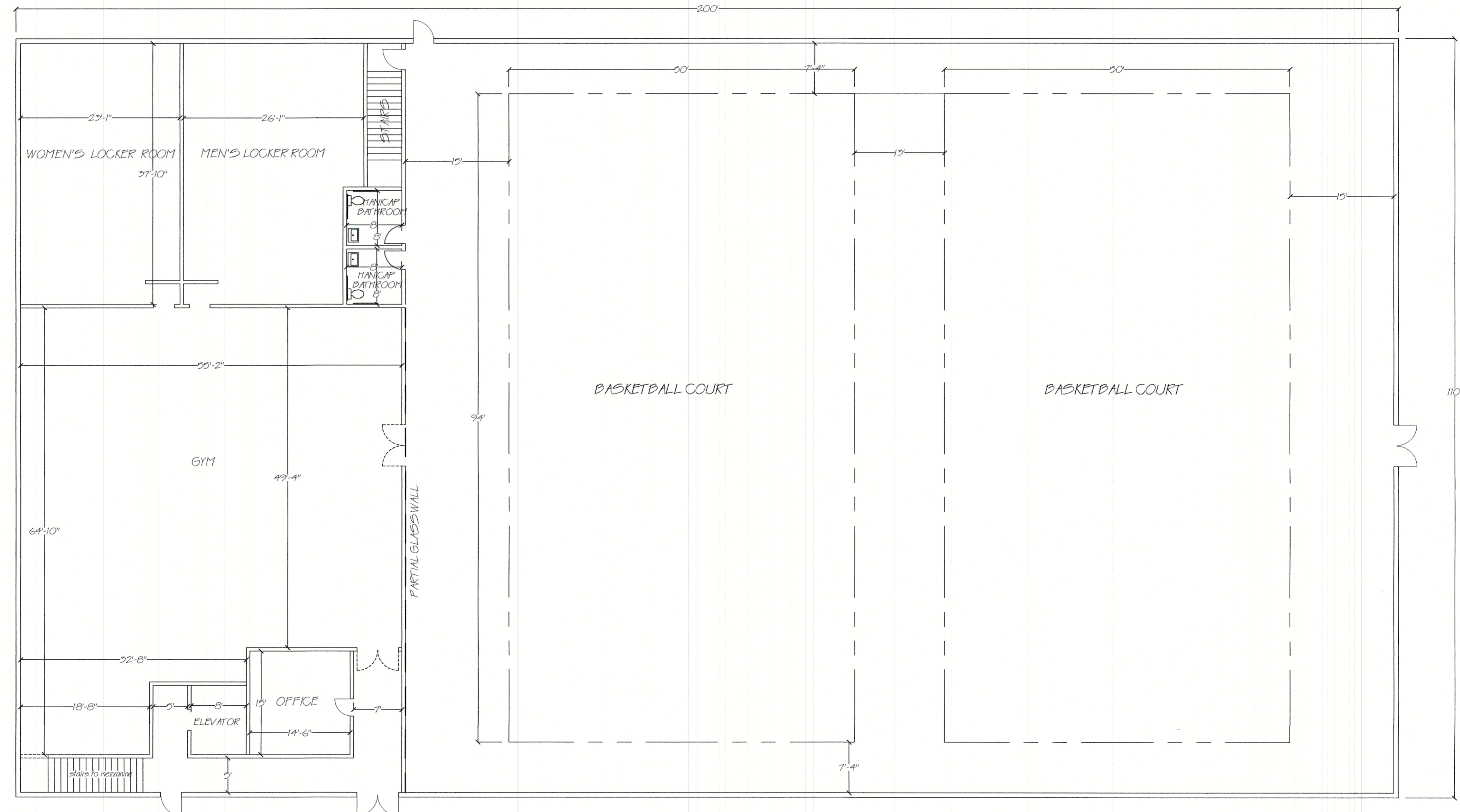

FIRST LEVEL

Professional Engineer Stamp

Professional Land Surveyor Stamp

Rhode Island State Law
 (Statute Chapter 39-1.2, Section 1)
 requires that Dig-Safe shall be notified
 48 hours prior to any excavation.
 1-888-DIG-SAFE / 1-888-344-7233 or 811
 EMERGENCY NUMBERS
 Gas-National Grid (1-800-936-7000)
 Water-EPDPW/Water Dept (435-7741)
 Sewer-Suez (433-6363)

PROPOSED POLICE PLANNING &
 TRAINING WELLNESS CENTER
 Map 406 Block 5 Parcel 1
 610 WATERMAN AVENUE
 East Providence, Rhode Island

DRAWN BY:	KLL
EX. COND. CHECKED BY:	CRH
DESIGNED BY:	KLL
DESIGN CHECKED BY:	EGS
APPROVED BY:	EGS
DATE DRAWN:	6 SEPT 2019
DATE SURVEYED:	NA
SURVEYED BY:	
SCALE:	3/32"=1'-0"
FILENAME:	2019130
LAST EDIT:	See Rev.

#	Date	Revision	By
1	9/30/19	Changes to design	KLL
2	10/6/19	Changes to design	KLL
3	1/29/20	Changes to design	KLL
4	5/6/20	Changes to design	KLL
5	6/10/20	Changes to design	SHC
5	3/11/21	Changes to design	KLL