

| FINISH SCHEDULE | | | | | | | | | | | | | | | |
|-----------------|-------------|-----------|-------------------|-----------------|-----------------|--------------|--------|--------------|--------|--------------|-----------------|--------------|-----------|------------------------|-------|
| ROOM NUMBER | ROOM NAME | FLOOR | | BASE | WALLS | | | | | | | | CEILING | | NOTES |
| | | SUBSTRATE | FINISH MATERIAL | FINISH MATERIAL | NORTH | | EAST | | SOUTH | | WEST | | SUBSTRATE | FINISH MATERIAL | |
| 101 | CLAM SHACK | CONC | | | GYP BD | | GYP BD | | GYP BD | | GYP BD | | GYP BD | | |
| 102 | MECH / ELEC | CONC | EPOXY PAINT | VINYL | GYP BD | PAINT | GYP BD | PAINT | GYP BD | PAINT | GYP BD | PAINT | GYP BD | ACP | |
| 103 | WOMEN | CONC | RESINOUS FLOORING | RESINOUS COVE | 8" CMU | PAINT | 8" CMU | PAINT | 8" CMU | PAINT | 8" CMU | PAINT | GYP BD | FRP | ACP |
| 104 | LAV | CONC | RESINOUS FLOORING | RESINOUS COVE | 8" CMU | PAINT | 8" CMU | PAINT | 8" CMU | PAINT | 8" CMU | PAINT | GYP BD | FRP | ACP |
| 105 | MEN | CONC | RESINOUS FLOORING | RESINOUS COVE | 8" CMU | PAINT | 8" CMU | PAINT | 8" CMU | PAINT | 8" CMU | PAINT | GYP BD | FRP | ACP |
| 106 | STORAGE | CONC | EPOXY PAINT | VINYL | 8" CMU / GYP BD | PAINT/FRP | GYP BD | PAINT | GYP BD | PAINT | 8" CMU / GYP BD | PAINT | GYP BD | ACOUSTICAL STEEL PANEL | |
| 107 | CLOSET | CONC | RUBBER | VINYL | GYP BD | PAINT | GYP BD | PAINT | GYP BD | PAINT | GYP BD | PAINT | GYP BD | ACP | |
| 108 | OFFICE | CONC | RUBBER | VINYL | GYP BD | PAINT | GYP BD | PAINT | GYP BD | PAINT | GYP BD | PAINT | GYP BD | ACP | |
| 109 | LAV | CONC | TILE | TILE | GYP BD | TILE / PAINT | GYP BD | TILE / PAINT | GYP BD | TILE / PAINT | GYP BD | TILE / PAINT | GYP BD | ACP | |

- GENERAL NOTES**
- ALL EXTERIOR WINDOWS TO RECEIVE 1" INSULATED UNITS U.O.N.
 - SEE BUILDING ELEVATIONS FOR WINDOW HINGE SIDE.
 - ALL STOREFRONT FRAMING MEMBERS TO BE 2 1/2" FACE WIDTH.
- LEGEND**
- 1 TEMPERED GLASS
 - 2 TEMPERED BOTH SIDES
 - S 1" INSULATED SPANDREL GLASS
 - M 2" INSULATED METAL PANEL. COLOR TO MATCH FRAME



650 Ten Rod Road
North Kingstown, RI 02852
v: 401.846.9583
f: 401.846.9583

Civil Engineers
Joe Casali Engineers
300 Post Road
Warwick, RI 02888
Phone: (401) 944-1300

Mechanical, Electrical, Plumbing Engineers
Andre Gill Engineering
North Smithfield, RI 02896
Phone: (401) 441-3414

Structural Engineers
C.A. Pretzer Associates
50 Freeway Drive
Cranston, RI 02920
Phone: (401) 785-2690

Landscape Architects
Diane C. Soule & Associates
422 Farmington Pike
Smithfield, Rhode Island
Phone: (401) 231-0736

E1 FINISH SCHEDULE
SCALE: 1:0.61

| DOOR SCHEDULE | | | | | | | | | | | | | | | |
|---------------|-------------|---------------|----------------|----------------|----------|------|----------|------|--------|------|--------------|-------------|-----------|---------|-------|
| DOOR NUMBER | DOUBLE LEAF | DOOR | | | | | FRAME | | | | HARDWARE SET | ACCESSORIES | THRESHOLD | SIGNAGE | NOTES |
| | | NOMINAL WIDTH | NOMINAL HEIGHT | LEAF THICKNESS | MATERIAL | ELEV | MATERIAL | ELEV | DETAIL | | | | | | |
| | | | | | | | | | HEAD | JAMB | | | | | |
| 101 | | 3' | 7' | 1 3/4" | ALUM | G | ALUM | 2 | H3 | J3 | SEE SPECS | SEE SPECS | T1 | | |
| 101A | | 3' | 7' | 1 3/4" | HM | F | HM | 1 | H3 | J3 | SEE SPECS | SEE SPECS | T1 | | |
| 102 | | 3' | 7' | 1 3/4" | HM | F | HM | 1 | H3 | J3 | SEE SPECS | SEE SPECS | T1 | | |
| 103 | | 3' | 7' | 1 3/4" | HM | F | HM | 1 | H3 | J3 | SEE SPECS | SEE SPECS | T1 | | |
| 104 | | 3' | 7' | 1 3/4" | HM | F | HM | 1 | H3 | J3 | SEE SPECS | SEE SPECS | T1 | | |
| 105 | | 3' | 7' | 1 3/4" | HM | F | HM | 1 | H3 | J3 | SEE SPECS | SEE SPECS | T1 | | |
| 106 | | 3' | 7' | 1 3/4" | HM | F | HM | 1 | H3 | J3 | SEE SPECS | SEE SPECS | T1 | | |
| 106A | X | 3' | 7' | 1 3/4" | HM | F | HM | 1 | H3 | J3 | SEE SPECS | SEE SPECS | T1 | | |
| 107 | | 3' | 7' | 1 3/4" | WD | F | HM | 1 | H3 | J3 | SEE SPECS | SEE SPECS | T1 | | |
| 108 | | 3' | 7' | 1 3/4" | ALUM | G | ALUM | 2 | H3 | J3 | SEE SPECS | SEE SPECS | T1 | | |
| 108A | | 3' | 7' | 1 3/4" | HM | F | HM | 1 | H3 | J3 | SEE SPECS | SEE SPECS | T1 | | |
| 109 | | 3' | 7' | 1 3/4" | WD | F | HM | 1 | H3 | J3 | SEE SPECS | SEE SPECS | T2 | | |
| OH1 | | 8'-0" | 8'-0" | 1 3/4" | ALUM | OH | | | | | SEE SPECS | | | | |
| OH2 | | 8'-0" | 8'-0" | 1 3/4" | ALUM | OH | | | | | SEE SPECS | | | | |

C1 DOOR SCHEDULE
SCALE: 1:0.48

| DOORS | | | | | |
|-----------|-----|---------|----------------------|--------------|---------|
| TYPE | --- | Flush | Flush | Glass Framed | Style 1 |
| ELEVATION | | | | | |
| W x H | --- | 36"x84" | 72"x84" | 36"x84" | 96"x96" |
| NOTES | --- | ELEV-F | ELEV-F (double leaf) | ELEV-G | ELEV-OH |

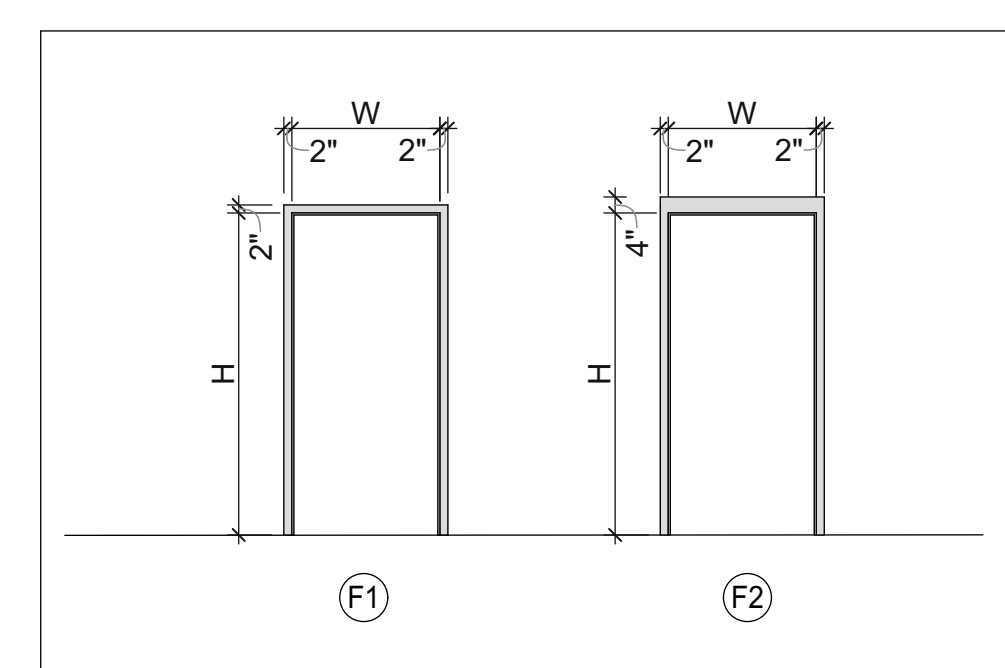

B3 TYP FRAME DETAILS
SCALE: 1/4" = 1'-0"

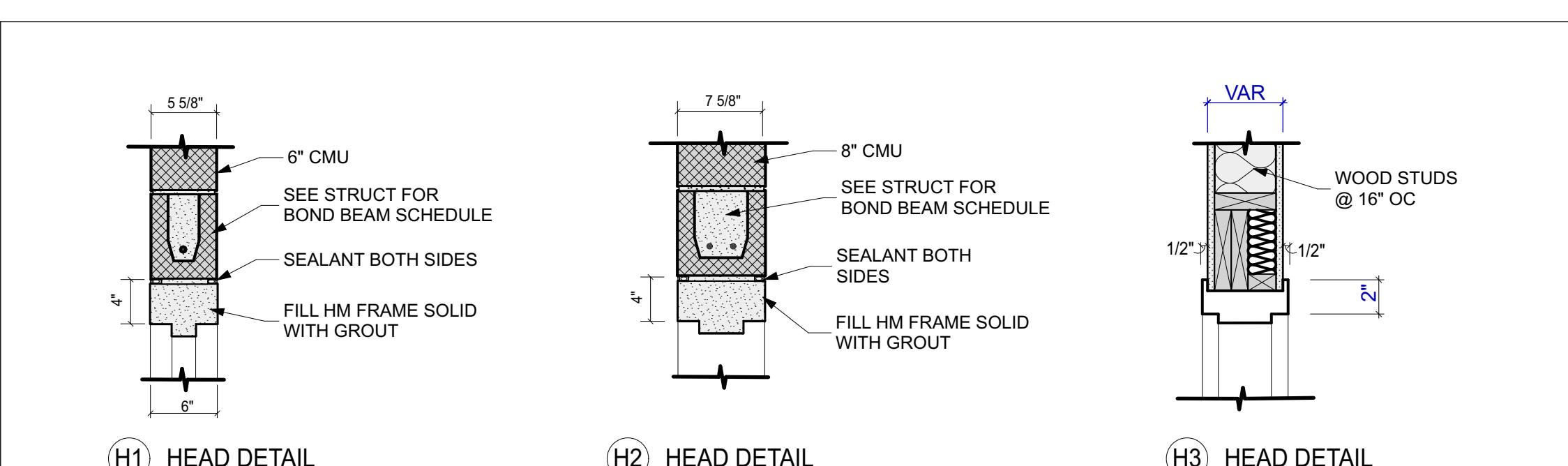

H1 HEAD DETAIL **H2 HEAD DETAIL** **H3 HEAD DETAIL**

B1 TYP DOOR ELEVATION
SCALE: 1" = 1'-0"

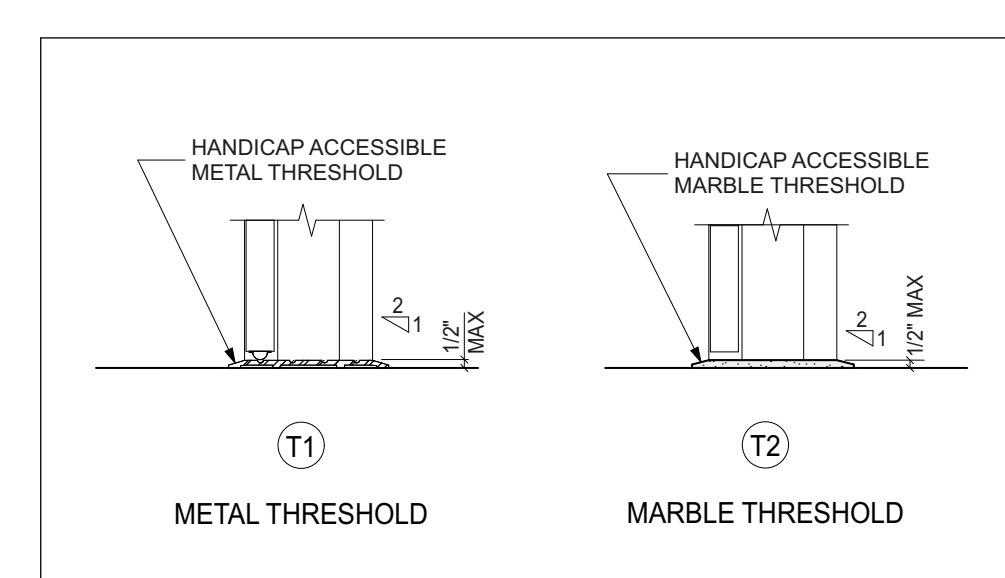

A3 TYP THRESHOLD DETAILS
SCALE: 1" = 1'-0"

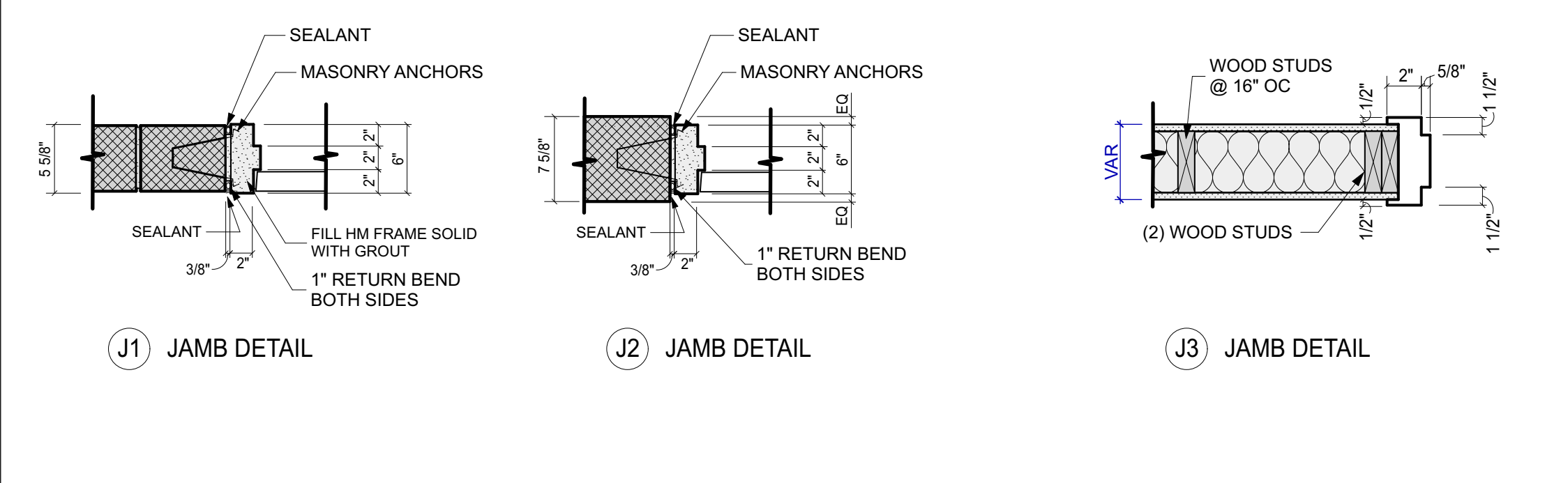

J1 JAMB DETAIL **J2 JAMB DETAIL** **J3 JAMB DETAIL**

A4 TYP DOOR DETAILS
SCALE: 1" = 1'-0"

**CRESCENT PARK
NEW BUILDING**
CITY OF EAST PROVIDENCE
684 & 700 BULLOCKS POINT AVENUE
RIVERSIDE, RI 02915

REVISIONS:

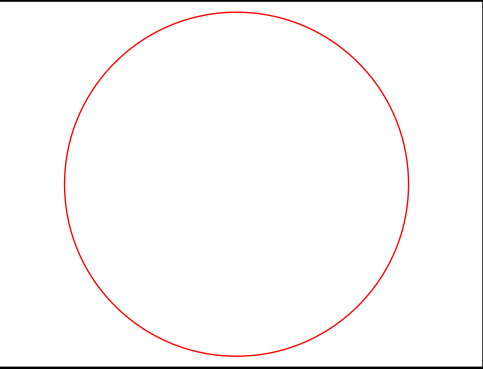

**SCHEDULES
and DETAILS**

DATE: 10/31/24

NCA JOB NO.: 23100

DRAWING NO.:

A-801