

DAVID SISSON ARCHITECTURE PC -- ALL RIGHTS RESERVED

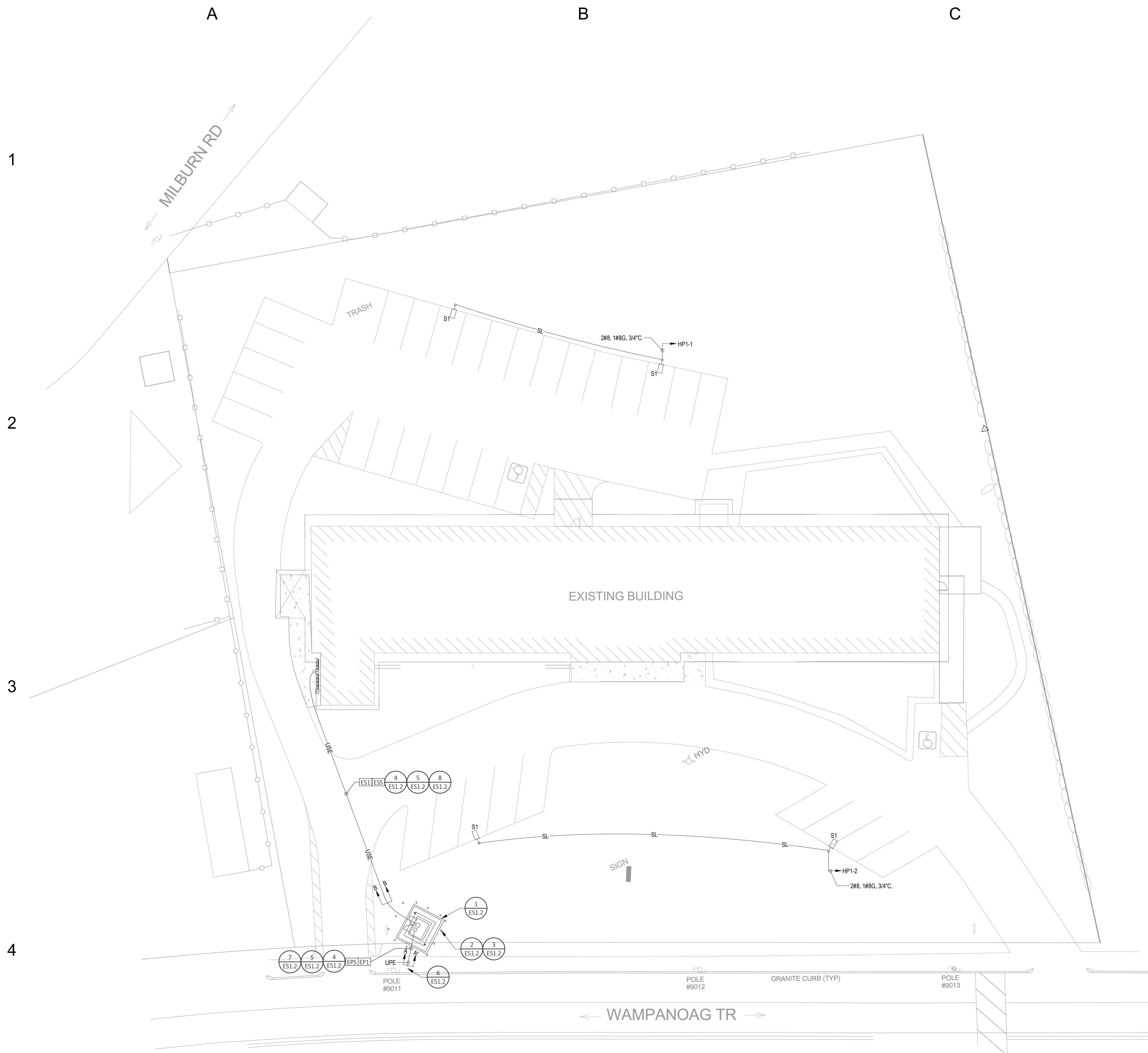

RI ENERGY IMPORTANT COORDINATION NOTE

1. RI ENERGY WORK ORDER NUMBER IS TBD. COORDINATION BETWEEN SITE/CIVIL CONSULTANT AND RI ENERGY IS ONGOING. ELECTRICAL CONTRACTOR SHALL VERIFY SERVICE CONDITIONS ON SITE TO BE MAINTAINED AND/OR MODIFIED TO SUIT NEW CONSTRUCTION. CONTRACTOR SHALL COORDINATE THE ELECTRICAL SERVICE PRIOR TO THE START OF THE WORK.

GENERAL SHEET NOTES

1. ELECTRICAL EQUIPMENT AND INSTALLATION SHALL BE PER RI ENERGY UTILITY COMPANY'S REQUIREMENTS.
2. TELECOMMUNICATIONS ENCLOSURES AND INSTALLATION SHALL BE PER THE SERVICE PROVIDERS REQUIREMENTS.
3. COORDINATE EXACT LOCATION OF TELECOMMUNICATION ENCLOSURES IN FIELD PRIOR TO ROUGH-IN.
4. DO NOT RUN ANY UNDERGROUND RACEWAYS WITHIN PLANTING AREAS OR LEACHING FIELDS. REFER TO CIVIL DRAWINGS FOR LOCATIONS. COORDINATE ROUTING WITH LANDSCAPE ARCHITECT.
5. REFER TO CIVIL DRAWINGS FOR EXACT ROUTING OF UTILITIES. REFER TO LANDSCAPE DRAWINGS FOR EXACT LOCATION OF 'SITE' FIXTURES.
6. ALL SITE WIRING SHALL BE 2#8, 1#8G, 1" MINIMUM UNLESS SHOWN OTHERWISE.
7. ALL EXTERIOR LIGHTING SHALL BE PROGRAMMED FOR TIMED "ON", TIMED "OFF". PROVIDE INDIVIDUAL CONTROL FOR EACH CIRCUIT. COORDINATE PROGRAMMING WITH OWNER.
8. REFER TO ARCHITECTURAL DRAWINGS FOR EXACT LOCATION OF EXTERIOR WALL MOUNTED LIGHTING.

DUCT SCHEDULE

- NOTES:**
1. REFER TO DUCT BANK SECTIONS FOR CORRESPONDING CONDUIT AND CONDUCTOR.
 2. REFER TO THE TYPICAL DUCT BANK SECTION FOR DETAIL REQUIRED IN CONSTRUCTION OF THE DUCT BANK ENVELOPE.
 3. REFER TO THE SPECIFICATIONS FOR ADDITIONAL INFORMATION INCLUDING, BUT NOT LIMITED TO, DUCT BANK REINFORCEMENT UNDER PAVES AREAS AS INTENDED FOR VEHICULAR TRAFFIC AND AT MANHOLE/BUILDING INTERFACES.
 4. ALL CONDUCTORS INSTALLED IN DUCT SHALL BE SUITABLE FOR WET LOCATIONS.
 5. ALL SERVICE ENTRANCE CONDUCTORS INSTALLED IN DUCT SHALL BE TYPE USE.
 6. PROVIDE ALL EMPTY/SPARE CONDUITS WITH CAPS AND NYLON PULL LINE.
 7. ELECTRICAL CONTRACTOR SHALL MANDREL AND PROVIDE NYLON PULL LINE.
 8. RUN CONDUITS OUTSIDE OF CLASS I, DIV I OR II AREAS.
 9. PROVIDE SEALING FITTINGS AT BOTH ENDS OF CONDUIT.
 10. COORDINATE EXACT TELECOMMUNICATIONS CONDUIT REQUIREMENTS WITH SERVICE PROVIDER(S) PRIOR TO START OF ANY...
 11. COORDINATE EXACT TEL/DATA REQUIREMENTS WITH EQUIPMENT/SIGN MANUFACTURER.

TAG	EQUIPMENT NAME	CONDUIT	CONDUCTORS	NOTES
EP1	PRIMARY ELECTRICAL SERVICE	1-4"	BY UTILITY COMPANY	1,2,3,4,7
EPS	PRIMARY ELECTRICAL SERVICE SPARE	1-4"	N/A	1,2,3,6,7
ES1	SECONDARY POWER FEEDERS	4-4"	SEE "POWER ONE-LINE"	1,2,3,4,5
ESS	SECONDARY SPARE	1-4"	N/A	1,2,3,4,6

david sisson architecture pc

 345 Taunton Ave

 East Providence RI 02914

 www.ds-arch.com info@ds-arch.com 401-955-7070

REV. #	DATE	ISSUED FOR:

100 Wampanoag Tr

 East Providence, RI 02915

 PROJECT NUMBER: 24051

ELECTRICAL SITE PLAN

CITY REVIEW

 03/03/2025

ES1.1

1 ES1.1

 ELECTRICAL SITE PLAN

 1/16" = 1'-0"

 TRUE NORTH

STEVEN COSTA

 No. 7813

 REGISTERED PROFESSIONAL ENGINEER (ELECTRICAL)

 Creative

 DIVISION OF THE REE GROUP

 HVAC-ELECTRICAL-PLUMBING-FIRE PROTECTION

 CREATIVE ENVIRONMENT CORP.

 180 FRANCES AVE BLDG. #2 GRANETON RI 02919

 OFFICE: 401-482-7100

 Creative No. 20241441

03/05/2025