



STARCK
ARCHITECTS



STARCK
ARCHITECTS



CITY of EAST PROVIDENCE

EAST PROVIDENCE COMMUNITY CENTER

PROPOSED EXTERIOR RENDERING
SEPTEMBER 19, 2023



STARCK
ARCHITECTS

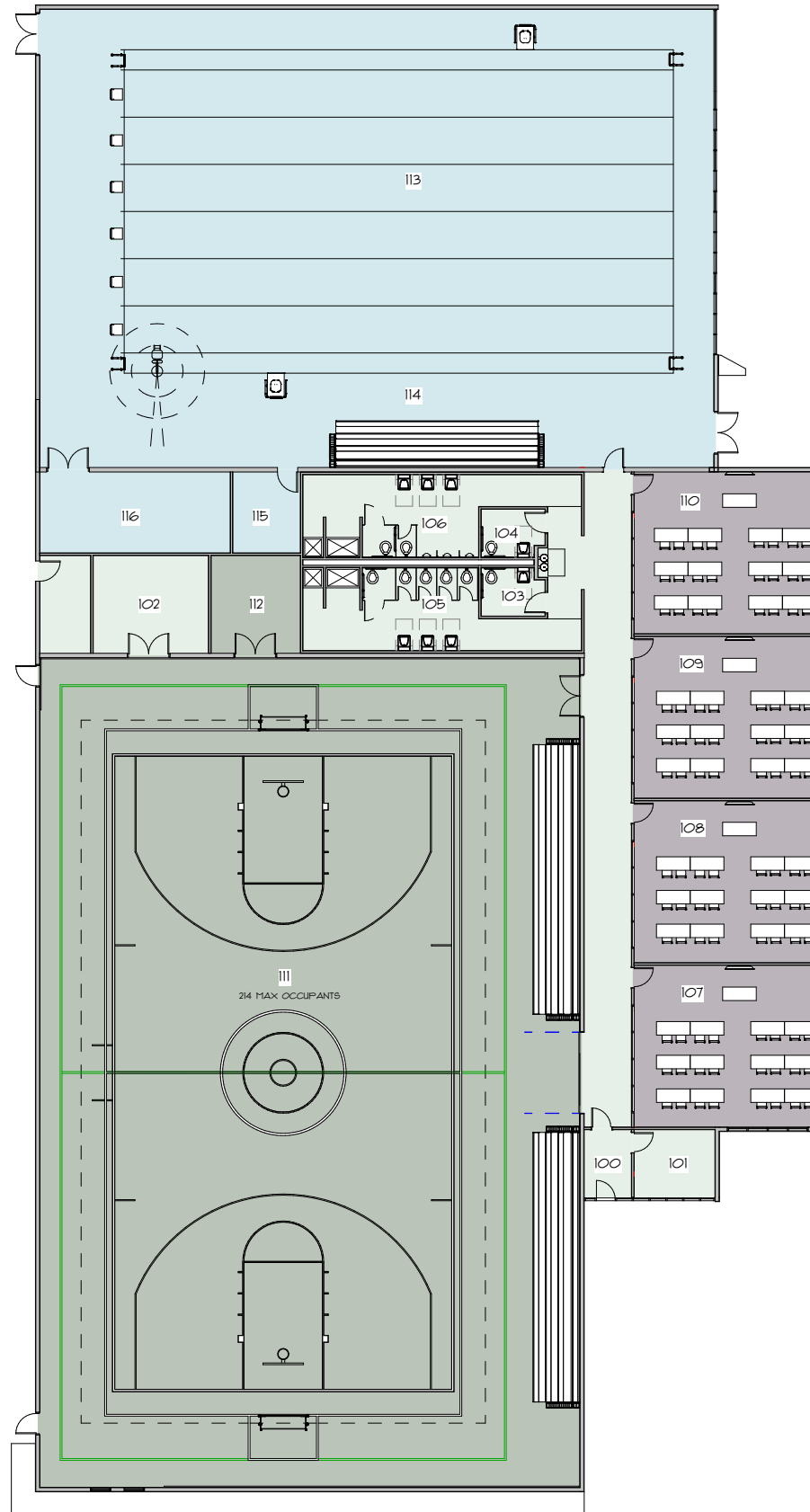

ROOM SCHEDULE		
NUMBER	NAME	AREA
PROGRAM SUPPORT		
	CIRCULATION	773 SF
100	VESTIBULE	70 SF
101	MAIN OFFICE	120 SF
102	MECHANICAL ROOM	363 SF
103	GENDER NEUTRAL RESTROOMS	65 SF
104	GENDER NEUTRAL RESTROOMS	65 SF
105	RESTROOM - MEN	388 SF
106	RESTROOM - WOMEN	387 SF
CLASSROOM		
107	CLASSROOM	648 SF
108	CLASSROOM	648 SF
109	CLASSROOM	648 SF
110	CLASSROOM	648 SF
RECREATION		
111	GYMNASIUM	9862 SF
112	REC. STORAGE	192 SF
POOL		
113	POOL	3912 SF
114	POOL DECK	2899 SF
115	POOL OFFICE	120 SF
116	POOL STORAGE	339 SF

TOTAL GROSS AREA: 23,005 SF



CITY of EAST PROVIDENCE



STARCK ARCHITECTS

PEREGRINE



GROUP LLC

TOTAL PROJECT BUDGET - ORDER OF MAGNITUDE				
EAST PROVIDENCE COMMUNITY CENTER				
East Providence, RI				
9.18.23				
DESCRIPTION	DRAFT BUDGET - OPTION 1	PSF		COMMENT
I. HARD COSTS				
Construction Cost				
Construction				
Pool	\$ 7,049,750	8,650		
Learning Center/Circulation/Support	\$ 2,600,000	4,000		
Gym	\$ 6,727,500	10,350		
Subtotal	\$ 16,377,250	23,000		
Owner Construction Contingency	\$ 1,000,000	6%		
HARD COSTS SUBTOTAL (with Contingency)	\$ 17,377,250	\$ 756	83%	ALLOWANCE
II. SOFT COSTS				
SEPTEMBER 19, 2023				
SOFT COSTS SUBTOTAL	\$ 2,606,588	\$ 113	13%	ALLOWANCE
III. FURNITURE, FIXTURES, EQUIPMENT & TECHNOLOGY				
FF&E/Technology Allowance Subtotal	\$ 868,863	\$ 38	4%	ALLOWANCE
IV. MISCELLANEOUS				
	\$ -	\$ -		
TOTAL PROJECT BUDGET	\$ 20,852,700	\$ 907		ALLOWANCE



CITY of EAST PROVIDENCE

EAST PROVIDENCE COMMUNITY CENTER

PROPOSED BUDGET
SEPTEMBER 19, 2023



STARCK ARCHITECTS

PEREGRINE



GROUP LLC

TOTAL PROJECT BUDGET - ORDER OF MAGNITUDE				
EAST PROVIDENCE COMMUNITY CENTER				
East Providence, RI				
9.18.23				
DESCRIPTION	DRAFT BUDGET - OPTION 2	PSF		COMMENT
I. HARD COSTS				
Construction Cost				
Construction				
Pool				Pool Removed
Learning Center/Circulation/Support	\$ 2,600,000	4,000		
Gym	\$ 3,250,000	5,000		Reduce Gym SF by +/-50% (half-court b-ball/no futsal)
Subtotal	\$ 5,850,000	9,000		
Owner Construction Contingency	\$ 1,000,000		17%	
HARD COSTS SUBTOTAL (with Contingency)	\$ 6,850,000	\$ 761	83%	ALLOWANCE
II. SOFT COSTS				
SOFT COSTS SUBTOTAL	\$ 1,027,500	\$ 114	13%	ALLOWANCE
III. FURNITURE, FIXTURES, EQUIPMENT & TECHNOLOGY				
FF&E/Technology Allowance Subtotal	\$ 342,500	\$ 38	4%	ALLOWANCE
IV. MISCELLANEOUS				
	\$ -	\$ -		
TOTAL PROJECT BUDGET	\$ 8,220,000	\$ 913		ALLOWANCE



CITY of EAST PROVIDENCE

EAST PROVIDENCE COMMUNITY CENTER

PROPOSED BUDGET
SEPTEMBER 19, 2023