



**Roberto L. DaSilva**  
**Mayor**

**Stephen Coutu**  
**Dir. Dept. of Public Works**

**FOR IMMEDIATE RELEASE**

November 30, 2020

**CONTACT INFO. :**

Office of the Mayor

Patricia Resende

(401) 529-3207

presende@eastprovidenceri.gov

*Note to editor: Please see attached detour map*

## **Road closures to commence due to infrastructure project**

EAST PROVIDENCE, RI – The City of East Providence and its contractor, D'Ambra Construction Co., will commence an infrastructure project to replace the South Broadway 72-inch culvert, which will result in the closing South Broadway at Lee Road for approximately three weeks.

The culvert is located near the intersection of Lee Road and South Broadway. During this phase of the project, residents' water will be turned off during the day to perform the work. That will begin on Wednesday, Dec. 2, 2020 between 7 a.m. and 4 p.m. to and is expected to run through to Friday, Dec. 4, 2020. Hang tag notices will be delivered notifying residents for the definitive date. Water will be on from 4 p.m. to 7 a.m.

###

*For more information, please contact the City's Engineering Dept. at 401-435-7703 EXT 8*

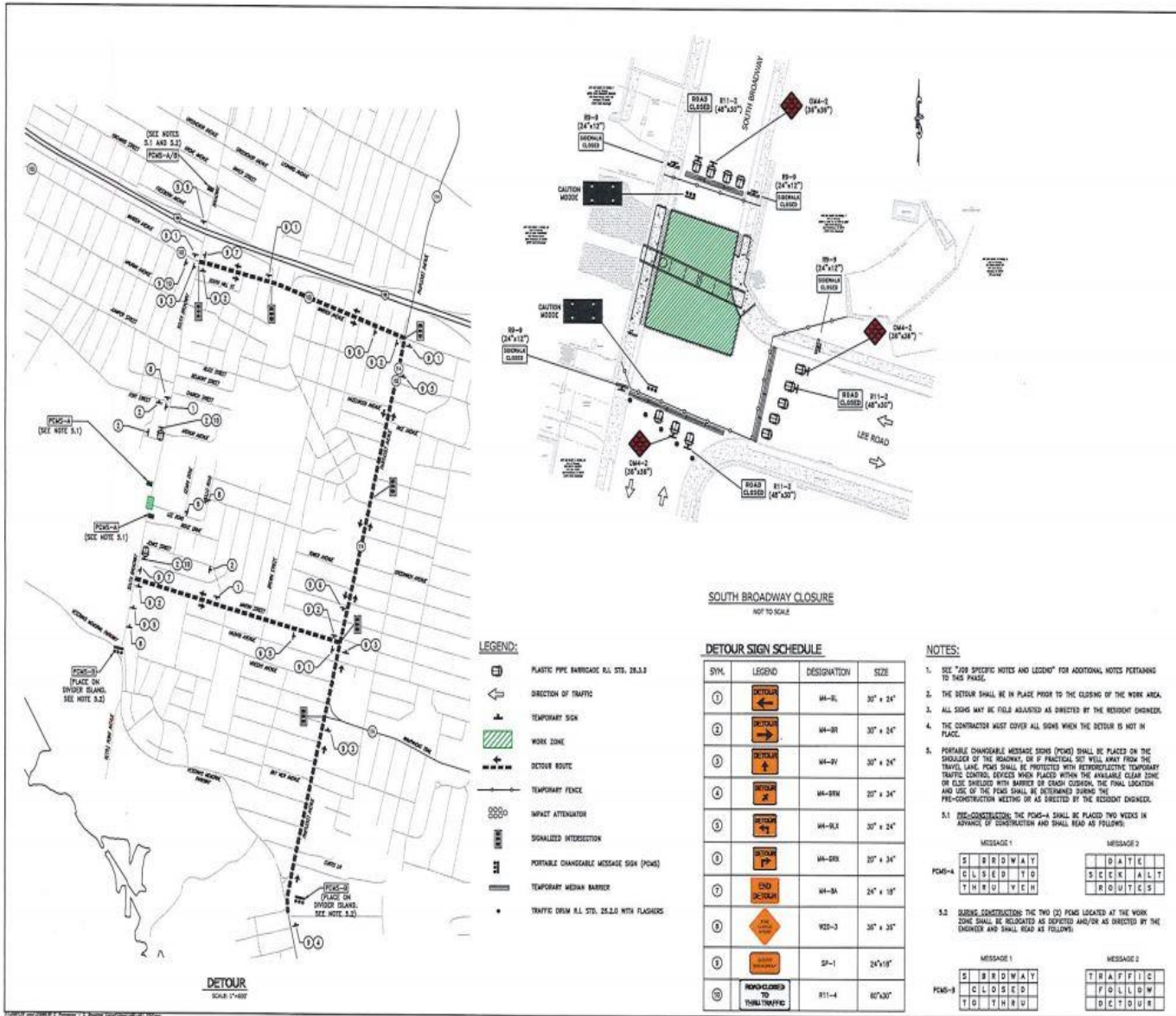

**PARE**  
PAVEMENT CONSTRUCTION  
INCORPORATING  
INTEGRITY - CONCRETE - ASPHALT  
12 WEST PARK BLVD. #200  
SOUTH BROADWAY  
EAST PROVIDENCE, RHODE ISLAND  
02914-1233

**D'AMBRA**  
CONSTRUCTION

SCALE ADJUSTMENT  
1" = 40' ON ORIGINAL DRAWING

**CITY OF EAST PROVIDENCE  
CULVERT REPLACEMENT PROJECT  
SOUTH BROADWAY  
EAST PROVIDENCE, RHODE ISLAND**

**DAVID J. EMBELL**  
REGISTERED PROFESSIONAL ENGINEER  
CIVIL  
No. 7127

REVISIONS:

NO.	DESCRIPTION	DATE

PROJECT NO.: 2088-08  
DATE: OCTOBER 2020  
SCALE: AS NOTED  
DESIGNED BY: DP  
CHECKED BY: ON  
DRAWN BY: RS  
APPROVED BY: ON

**TEMPORARY TRAFFIC CONTROL PLAN 2**

SHEET NO.: **C4.1**